

# DROP-IN SINKS

One Compartment - FOR GENERAL PURPOSE USE



**Sinks Include Faucet & Drain**

Item #: \_\_\_\_\_ Qty #: \_\_\_\_\_  
 Model #: \_\_\_\_\_  
 Project #: \_\_\_\_\_



**DI-1-168**  
18 Gauge



**DI-1-208**  
18 Gauge



**DI-1-2012**  
18 Gauge



**DI-1-30**  
20 Gauge



**DROP-IN FILLER STATION**  
**DI-1-9**  
20 Gauge



**LARGEST ONE COMPARTMENT DROP-IN SINK IN THE INDUSTRY!**  
**Supplied with K-53 Faucet**  
**DI-1-2812**  
16 Gauge

**FEATURES:**

One piece seamless **Deep Drawn** sink bowl design. All sink bowls have a large liberal radii with a minimum dimension of 2" and are rectangular in design for increased capacity.  
 Self-Rim Design. Mounting clips provided and accommodate counters up to 2" thick. (Quantity supplied varies based on drop in sink ordered).

- DI-1-30 & DI-1-168:** includes 4" O.C. **K-52** faucet.
- DI-1-208 & DI-1-2012:** includes 4" O.C. **K-50** faucet.
- DI-1-2812:** includes 4" O.C. **K-53** faucet.
- DI-1-9:** includes single hole **K-54** filler faucet.

**DI-1-9** has Removable Electro-Polished stainless steel grill.

**CONSTRUCTION:**

Unit fabricated from one sheet of stainless steel. All bowls are Sound Deadened. Units feature Advance Tabco's **Smart Finish™**.

**MECHANICAL:**

Faucet supply is 1/2" IPS male thread. Deck mounted faucet is furnished with aerator. **DI-1-9** includes deck mounted faucet furnished with "Push-Back" actuator.

**MATERIAL:**

Type 304 series stainless steel. Faucets are brass-nickel plated. Stainless Steel 1-1/2" IPS basket drain.



STANDARD MOUNTING CLIPS  
Accommodates Countertops up to 2"  
Replacement # **K-28** (Per Sink)

Available Faucets & Accessories	Model #	Qty
Deck Mounted 8" Swing Spout. 4" O.C.	<b>K-50</b>	
Deck Mounted Gooseneck. 4" O.C.	<b>K-52</b>	
Deck Mounted. 12" Swing Spout. 4" O.C.	<b>K-53</b>	
Water Filler Faucet (Single Hole)*	<b>K-54</b>	
Deck Mounted 8 1/2" Gooseneck. 4" O.C.	<b>K-55</b>	
Deck Mounted Swing w/Spray. 8" O.C.*	<b>K-58</b>	
Deck Mtd. X.H.D. 3 1/2" Gooseneck. 4" O.C.	<b>K-62</b>	
Thick-Counter Mounting Clips for Countertops over 7/8" and up to 2". (Qty. supplied varies based on sink ordered)	<b>K-28</b>	

\*REQUIRES **K-472** FAUCET HOLE REVISION

**Standard Faucet conforms to NSF 61 Standard 9.**  
**An optional faucet upgrade is required for compliance to AB 1953 Standards.**

For Replacement Faucets & Upgrades, Drains & Accessories visit our website at [www.advancetabco.com](http://www.advancetabco.com)

# DIMENSIONS and SPECIFICATIONS

TOL ± .125"

ALL DIMENSIONS ARE TYPICAL

## DI-1-208 & DI-1-2012

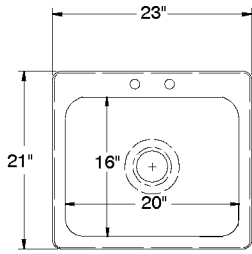

**Cut-Out Size**  
22 1/4" x 20 1/4"  
1 1/4" radius corners

### DI-1-208

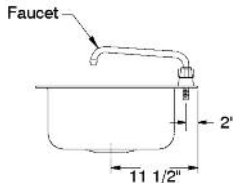

Approx. Wt. 18 lbs.

### DI-1-2012

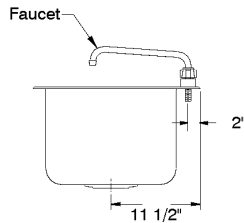
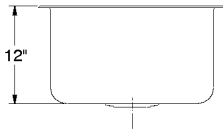

Approx. Wt. 20 lbs.

Supplied with K-50 Faucet

## DI-1-2812

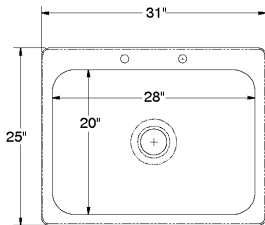

**Cut-out Size**  
30 1/4" x 24 1/4"  
1 1/4" radius corners

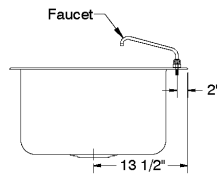
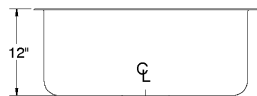

Approx. Wt. 42 lbs.

Supplied with K-53 Faucet

## TYPICAL INSTALLATION

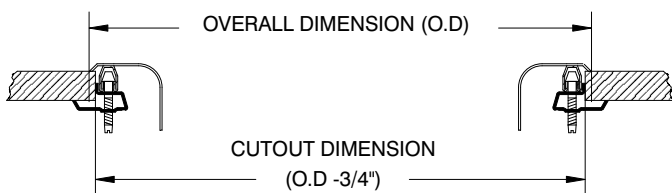

Cut-Out Size = L to R x F to B

## DI-1-168

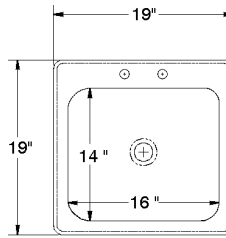

**Cut-out Size**  
18 1/4" x 18 1/4"  
1 1/4" radius corners

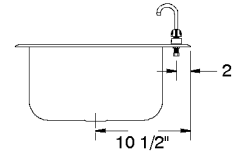
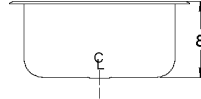

Approx. Wt. 15 lbs.

Supplied with K-52 Faucet

## DI-1-30

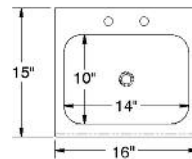

**Cut-Out Size**  
15" x 14 1/4"  
1 1/4" radius corners

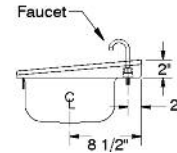
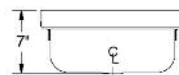

Approx. Wt. 11 lbs.

Supplied with K-52 Faucet

## DI-1-9

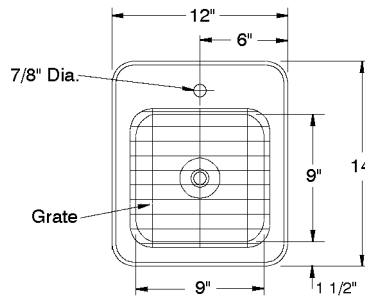

**Cut-Out Size**  
11 1/4" x 13 1/4"  
1 1/4" radius corners

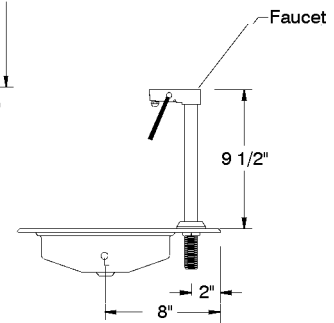
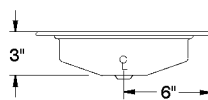

Approx. Wt. 15 lbs.

Supplied with K-54 Faucet

