

## AutoPOD™ Auto Eject Pod Brewer

ITEM#

PROJECT

DATE



### Model AutoPOD

Dimensions: 15.8" H x 9.7" W x 15.2" D  
(40.1cm H x 24.6cm W x 38.6cm D)

### Features

#### AutoPOD Pod Brewer

**Commercial-grade, single-cup system  
with the convenience of automatic pod disposal**

- Eliminates waste by brewing one fresh cup at a time from a wide variety of coffee and tea pods.
- Automatically disposes of spent pods after each brew.
- Removable pod bin holds up to 25 spent pods.
- Pod bin and drip tray can be modified for under-counter disposal of pods.
- Works with most common coffee and tea pods.
- Patent pending sprayhead design allows for proper extraction of all flavoring materials and aromatics.
- Brews up to 16 ounces of coffee or tea in less than a minute.
- Digital display in English/Spanish for easy programming, operation and control.
- Control extraction utilizing pulse-brew technology with BrewMETER®.
- Push and hold hot water button provides up to 10 ounces of hot water for cappuccino, cocoa and soups.
- Integrated cup booster allows for 5" or 8" cup clearance.
- Energy-saver mode reduces tank temperature during idle periods.
- Recipe labels provided allow for customization of beverages dispensed.
- Ready to use out of the box.

For current specification sheets and other information, go to [www.bunn.com](http://www.bunn.com).

### Related Products

#### Brew Station

Product No.: 39501.0001  
(brewer and accessories  
not included)



#### Coffee Wipes

Product No.: 38450.0000  
individual towel



#### Rack Assembly

Product No.: 39502.0001  
(pods not included)



#### Model

AUTOPOD

#### Agency Listing



Patents Apply

5/09

A7.4

## Dimensions & Specifications

Model	Product #	Volts	Amps	Tank Heater Watts	Total Watts	Brewing Capacity	Cu. Ft.	Shipping Weight	Cord Attached
AutoPOD	40300.0000	120	12.1	1450	1450	16 oz/minute	2.34	29.5 lbs	Yes*
AutoPOD	40300.0001 <sup>†</sup> (pump model)	120	12.1	1450	1450	16 oz/minute	2.34	30 lbs	Yes*

<sup>†</sup>For use in areas with inconsistent water pressure. Compatible with use on a Shurflo or Flojet pump system.

\*Power cord (NEMA 5-15P) 15 Amp-120V machine only.

**Brewing capacity:** based upon incoming water temp of 60°F/15°C (140°F/60°C rise).

Electrical: Model requires 2-wires plus ground service rated 120V, single phase, 60Hz.

Plumbing: 20-90 psi (138-621 kPa). Machine supplied with 1/4" OD male flare fitting.

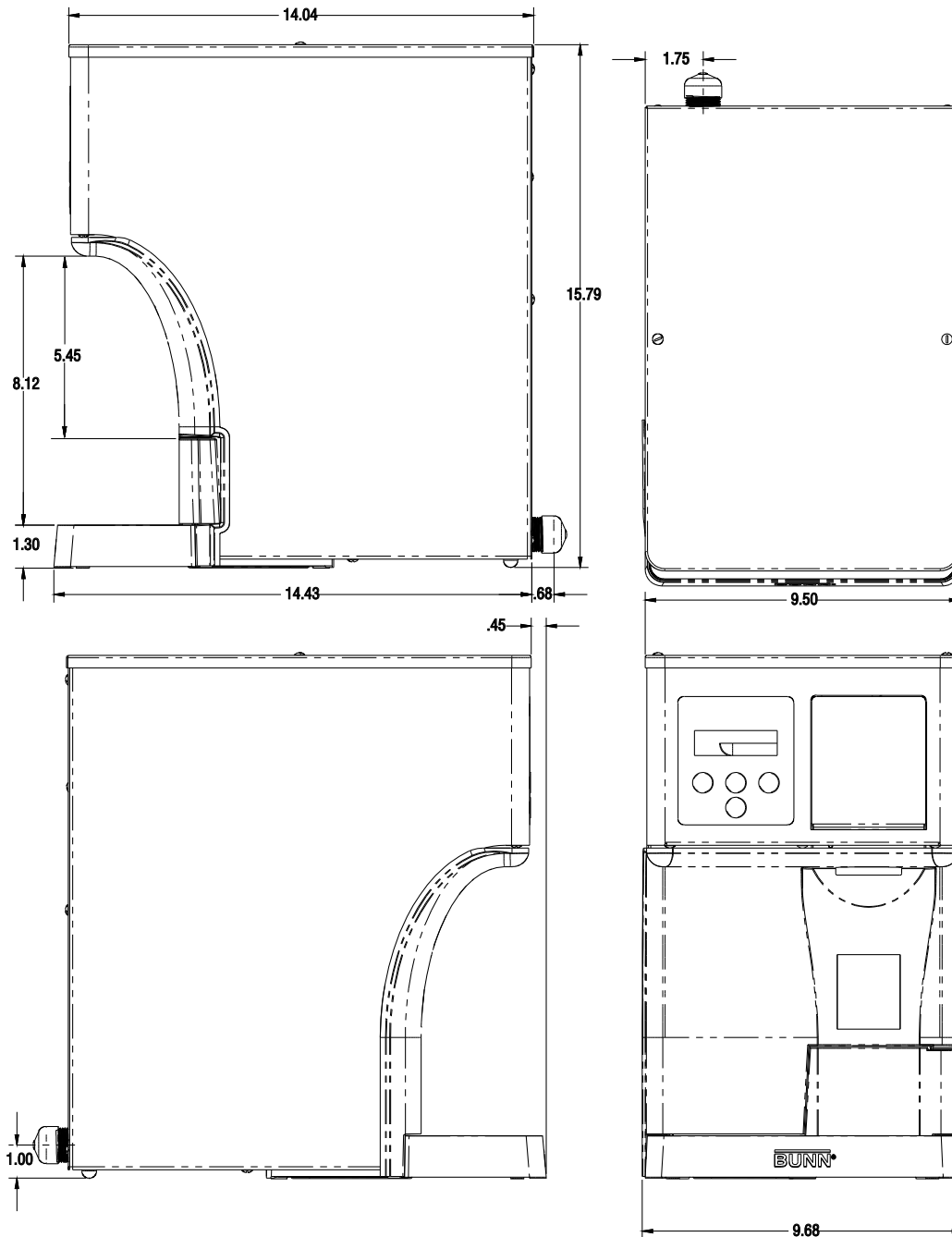

Bunn-O-Matic® Corporation - 1400 Stevenson Drive Springfield, Illinois 62703 • 800-637-8606 • 217-529-6601 • Fax 217-529-6644 • www.bunn.com

BUNN® practices continuous product research and improvement. We reserve the right to change specifications and product design without notice. Such revisions do not entitle the buyer to corresponding changes, improvements, additions or replacements for previously purchased equipment.

All dimensions shown in inches.