

PROJECT	
ITEM #	
QUANTITY	DATE
APPROVAL	

# SH & SH-NU

## Mobile Heated Serving Counters

### Short Form Specifications

**Exterior body** is constructed of 18-gauge stainless steel side panels and 14-gauge galvanized bottom. All exterior side panels are reinforced with overlapping corners and are welded in place. All body cutouts are reinforced with 14-gauge galvanized channel supports.

**Exterior top** is constructed of 14-gauge stainless steel, welded, ground and polished into one integral unit. Top is fabricated with square exterior corners. Top has two to six electrically heated, recessed, die-stamped stainless steel hot food warmers. Each warmer accommodates one 12.75" x 20.75" x 6" (32.4cm x 52.7cm x 15.2cm) pan.

**Heated food warmers** are constructed of die-stamped stainless steel. Heated food warmers are insulated on bottom. Each heated food warmer is individually equipped with a heated element rated at 1000 watts for 120 volt or 208/230 volt, 60 hertz, single phase service and wired to an adjustable control switch and indicator light in the control panel. Heated food warmers are interwired to a maximum 10' (3m) long cord with a grounded plug for 120 volt or 208/230 volt, 60 hertz, single phase electrical service.

**Castors:** Unit is mounted on 5" (12.7cm) diameter swivel casters with non-marking polyolefin tires and plate brakes. Overall height of caster assembly is 6.00" (15.2cm).

### The following applies to SH Series only.

All SH models have a one door heated compartment. Compartment is constructed of 18-gauge stainless steel, is insulated with a minimum of 2" (5.1cm) insulation and is provided with removable 16-gauge pan slides. SH-2 comes with a single capacity heated compartment; compartment that holds four 12.75" x 20.75" x 2.5" (32.4cm x 52.7cm, x 6.4cm) pans. SH-3, SH-4, SH-5 and SH-6 units come with double capacity (single door) heated compartment with a center partition; compartment holds eight 12.75" x 20.75" x

2.5" (32.4cm x 52.7cm, x 6.4cm) pans. With the center partition removed the double capacity compartment can hold four 18" x 26" (45.7cm x 66cm) sheet pans. The internally mounted heating element is rated at 890 watts, has a louvered protective cover and is wired to a temperature control thermostat and indicator light in the stainless steel control panel. Doors are built with double-wall construction, with gaskets and stainless steel front panel.

### Optional Accessories and Modifications:

- A) 12" (30.5cm) wide stainless steel fold-down tray slide
- C) 10" (25.4cm) wide three-bar fold-down tray slide
- D) 10" (25.4cm) wide composite fold-down cutting boards
- E) 10" (25.4cm) wide stainless steel fold-down work shelf
- F) Line-up interlock device
- G) Glass-front counter protector
- H) Two tier display with glass shelves and sneezeguards
- HD) Dual service two tier display with sneezeguards
- I) Three tier display with glass shelves and sneezeguards
- J) 12" (30.5cm) wide 18-gauge stainless steel overshef
- KS) Single service flip-up sneezeguard
- KD) Double service flip-up sneezeguard
- LI) \*Incandescent light fixtures
- LD) Laminate door panel insert (SC Series only)
- M) \*Radiant heat lamps
- MB) \*Bullet-style heat lamps
- P) Open understorage with shelf (SC-NU Series only)
- Q) \*120V/60Hz/1Ø, 10 amp convenience outlet with breaker
- QQ) Drains from food wells, plumbed to common valve
- SG5A) Single dry insert with door (SH-NU units only)
- SG5B) Double dry insert with doors (SH-NU units only)
- ST) Stainless steel trim strips
- U) 14" x 30" (35.6cm x 76.2cm) stainless steel end drop shelf
- V) 6" (15.2cm) high adjustable stainless steel legs in lieu of casters
- X) Laminate exterior panels in lieu of stainless steel exterior panels

\*Inclusion of these options will alter the electrical specifications of unit.



**Model SH-3-NU**

shown with option A and G



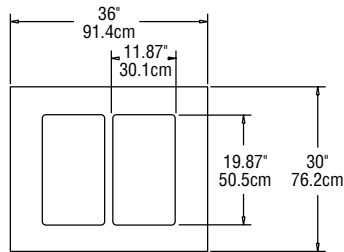

**PLAN VIEW  
SH-2/SH-2-NU**

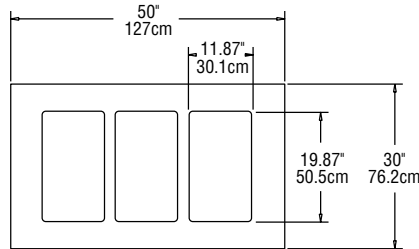

**PLAN VIEW  
SH-3/SH-3-NU**

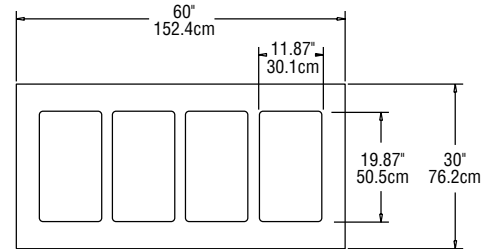

**PLAN VIEW  
SH-4/SH-4-NU**

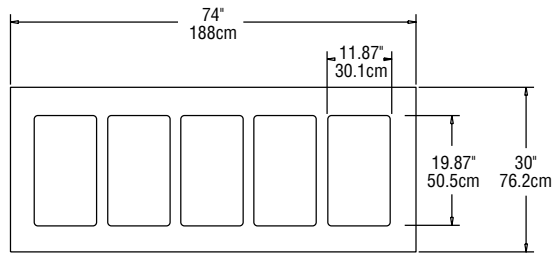

**PLAN VIEW  
SH-5/SH-5-NU**

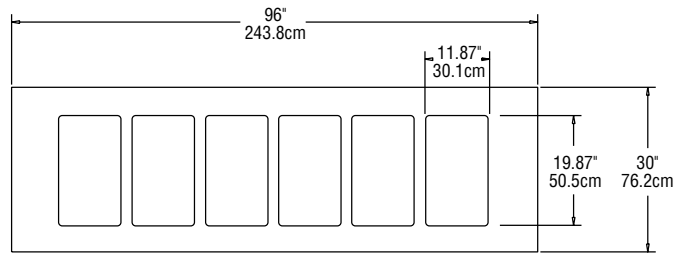

**PLAN VIEW  
SH-6/SH-6-NU**

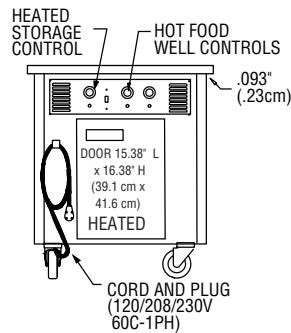

**ELEVATION VIEW  
SH-2**

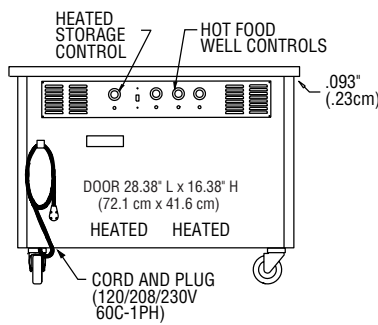

**ELEVATION VIEW  
SH-3/SH-4/SH5/SH-6**

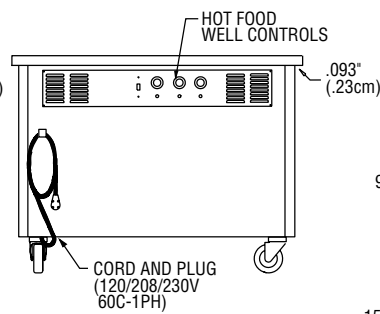

**ELEVATION VIEW  
ALL SH-NU MODELS**

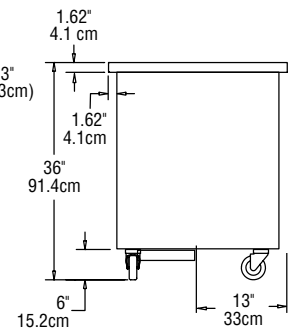

**END VIEW  
ALL MODELS**

### Mechanical Data — Standard Unit

MODEL NUMBER	PAN CAP. 12" X 20"	PAN CAP. 18" X 26"	AMP	NEMA PLUG	SHIP WEIGHT LBS./KG.
<b>SH-2</b>	4	—	15.0	14-20P	380/172
<b>SH-3</b>	8	4	20.0	14-30P	460/209
<b>SH-4</b>	8	4	26.0	14-50P	550/250
<b>SH-5</b>	8	4	31.0	14-50P	660/299
<b>SH-6</b>	8	4	37.0	14-50P	720/327

MODEL NUMBER	AMP	NEMA PLUG	SHIP WEIGHT LBS./KG.
<b>SH-2-NU</b>	11.0	14-20P	225/102
<b>SH-3-NU</b>	16.0	14-20P	275/125
<b>SH-4-NU</b>	22.0	14-30P	330/150
<b>SH-5-NU</b>	28.0	14-50P	420/191
<b>SH-6-NU</b>	32.0	14-50P	510/231

All SH & SH-NU units use a 120/208-230 Voltage, 60 Hertz, single phase electrical system.

The Delfield Company, 980 S. Isabella Rd., Mt. Pleasant, MI 48858, U.S.A. • (800) 733-8821 • Fax (800) 669-0619 • www.delfield.com  
Delfield reserves the right to make changes in design or specifications without prior notice. ©2002 The Delfield Company. All rights reserved. Printed in U.S.A.