



PROJECT	
ITEM #	
QUANTITY	DATE
APPROVAL	

## ST4448N/STD4448N/UC4448N/UCD4448N

### Front-Breathing Flat Top and Undercounter Refrigerated Bases

#### Short Form Specifications

**Exterior top** is one-piece 22-gauge stainless steel with integral 2.12" (5.1cm) square nosing at the front.

**Exterior back and bottom** are two-piece 24-gauge galvanized steel. Exterior ends are stainless steel.

**Interior sides** are thermoformed ABS plastic with integral shelf supports. Base is fully insulated with high-density foamed in place polyurethane.

**Refrigeration system** uses HFC-404A refrigerant. Compressor is 1/4 H.P., with condenser coil and condensate evaporator mounted on rear of the cabinet. Evaporator coil and temperature control are located on the interior rear wall of the cabinet. Refrigerant flow is controlled by a capillary tube. Cabinet maintains an interior cabinet temperature of 36°F to 40°F (2°C to 4°C).

**Electrical connection** is 115 volt, 60 Hertz, single phase. Unit has an 8' (2.4m) long electrical cord and NEMA 5-15P plug.

**Casters:** Equipment is mounted on 2" (5.08cm) diameter plate casters with front two locking. Equipment clearance above the floor is 2.5" (6.35cm).

**Doors** have a 22-gauge stainless steel exterior, with thermoformed ABS plastic interior liner. Cabinet is supplied with one adjustable epoxy-coated wire shelf per door opening.

**Drawers** have 22-gauge stainless steel exterior with thermoformed ABS plastic interior liner. Drawer frames are 14-gauge stainless steel. Drawer slides are 14-gauge stainless steel with stainless steel bearings. Each top drawer holds one 12" x 20" (30.5cm x 50.8cm) pan 4" -6" (10.1cm-15.2cm) deep. Each bottom drawer holds one 12" x 20" (30.5cm x 50.8cm) pan 4" (10.1cm) deep. Pans are supplied by others.

#### Optional Accessories and Modifications

- 2" x 4" high stainless steel backsplash
  - 18" wide single tier overshelf
  - Plastic laminate on front
  - Additional wire shelves
  - Door lock
  - 36" height available on UC model
  - \*220V/50 Hertz electrical system
- \*Inclusion of this option will alter electrical specifications of the unit.



Model UC4448N





# ST4448N/STD4448N/UC4448N/UCD4448N

## Front-Breathing Flat Top and Undercounter Refrigerated Bases

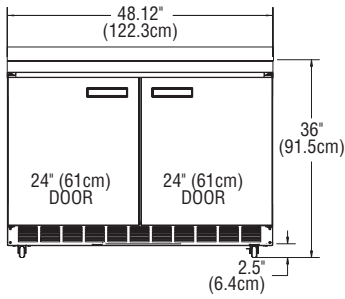

**ELEVATION VIEW  
ST4448N**

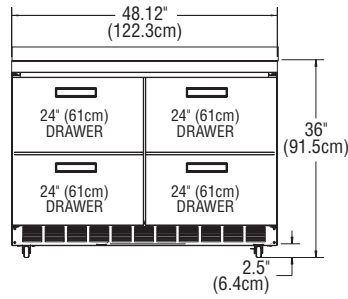

**ELEVATION VIEW  
STD4448N**

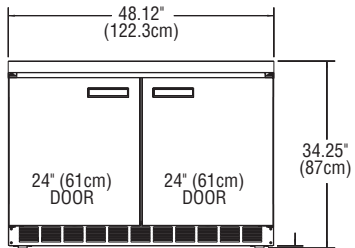

**ELEVATION VIEW  
UC4448N**

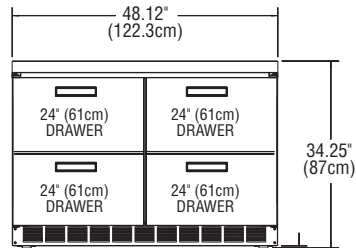

**ELEVATION VIEW  
UCD4448N**

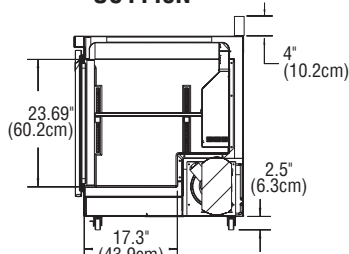

**END VIEW  
ST4448N**

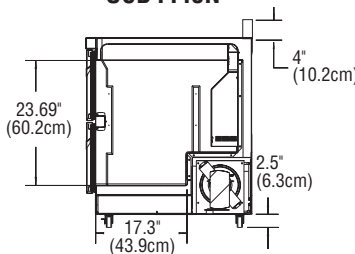

**END VIEW  
STD4448N**

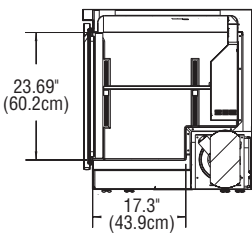

**END VIEW  
UC4448N**

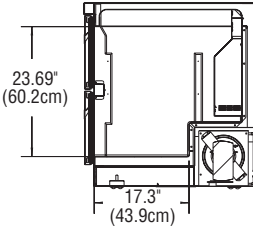

**END VIEW  
UCD4448N**

**INSTALLATION NOTE:**  
Refrigeration system is designed so that air will flow under the unit, through the compressor area and out the front of the unit. Any restriction to this air flow path will void the warranties.

**NOTE:** UC models are shipped with an alternate caster kit reducing overall height to 34.25" (87cm)



**PLAN VIEW  
ALL MODELS**

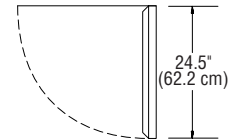

**DOOR CLEARANCE  
DETAIL**

### Mechanical Data—Standard Unit

MODEL NUMBER	#OF SHELVES	SHELF AREA. SQ. FT.	STORAGE CAP. CU. FT.	H.P.	VOLTS/HERTZ/ PHASE	AMPS	NEMA PLUG	SHIP WEIGHT
<b>ST4448N</b>	2	4.18	10.7	1/5	115/60/1	6.5	5-15P	335 lbs/ 152 kg
<b>STD4448N</b>	N/A	N/A	2.7	1/5	115/60/1	6.5	5-15P	370 lbs/ 168 kg
<b>UC4448N</b>	2	4.18	10.7	1/5	115/60/1	6.5	5-15P	335 lbs/ 152 kg
<b>UCD4448N</b>	N/A	N/A	2.7	1/5	115/60/1	6.5	5-15P	370 lbs/ 168 kg