

3/4-14 UN  
Female Outlet

3/4-14 UN  
Female Inlet

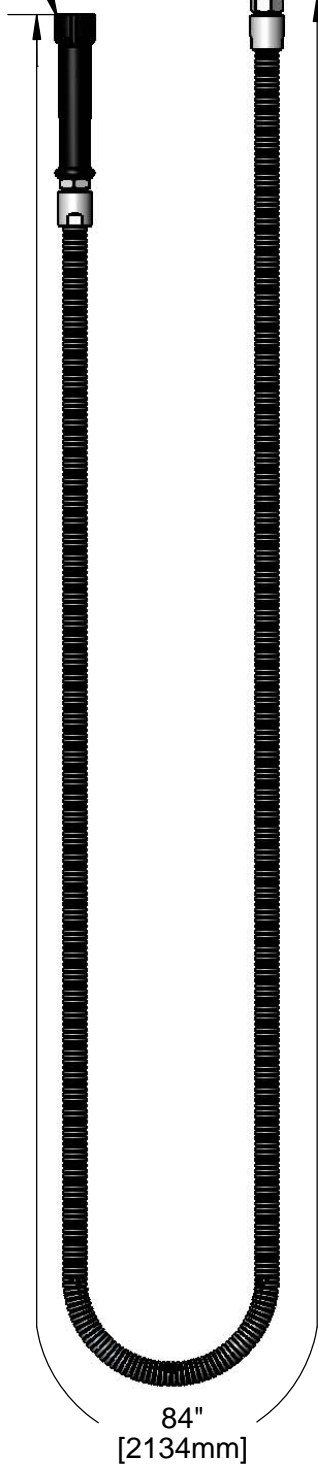

84"  
[2134mm]

*This Space for Architect/Engineer Approval*

Job Name \_\_\_\_\_ Date \_\_\_\_\_

Model Specified \_\_\_\_\_ Quantity \_\_\_\_\_

Customer/Wholesaler \_\_\_\_\_

Contractor \_\_\_\_\_

Architect/Engineer \_\_\_\_\_



(2) 010476-45  
Washers Furnished  
w/ Hose

Model Number

**5HSE84**

Product Specifications:

**84" Flexible Stainless Steel Hose w/ Black Handle & Polyurethane Inner Hose**

Product Compliance:

ASME A112.18.1 / CSA B125.1  
NSF 61 - Section 9  
NSF 372 (Low Lead Content)

equip  
Foodservice  
Accessories

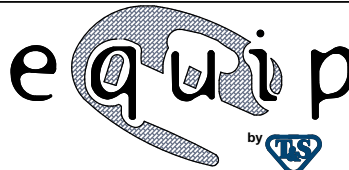

2 Saddleback Cove, P.O. Box 1088  
Travelers Rest, South Carolina 29690  
Phone: 800.891.4808 Fax: 800.868.0084  
equip.tsbrass.com

Drawn: JBC

Checked: JRM

Approved: JHB

Date: 08/08/17

Scale: 1:6

Sheet: 1 of 2

ITEM NO.	SALES NO.	DESCRIPTION
1	001014-45	Washer, B-0100 Hose Barrel
2	000729-40	Nut, 7/8-20 Male x 3/4-14 Female
3	010476-45	#27 Washer

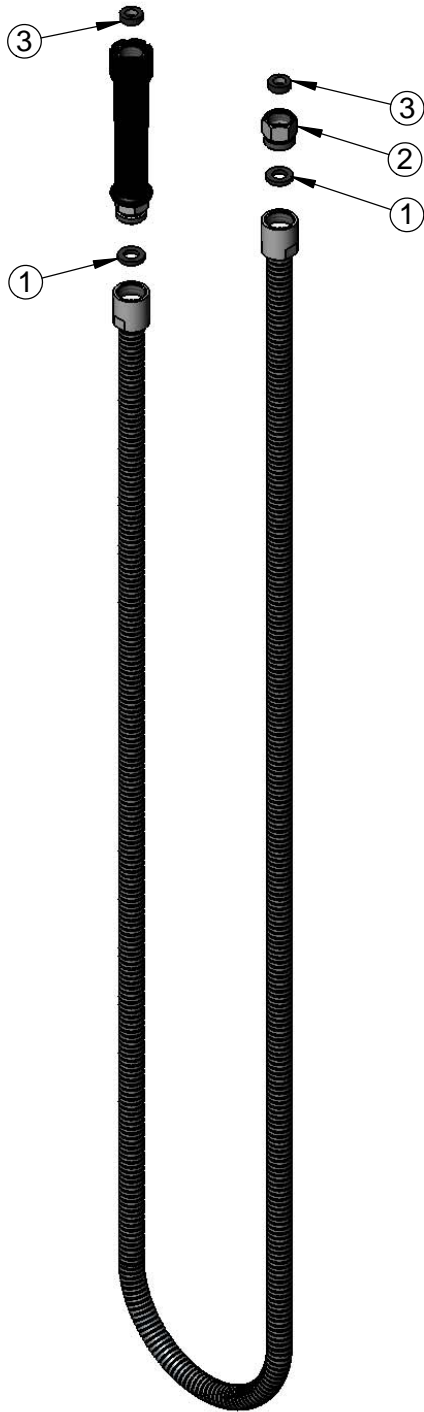

Model Number

**5HSE84**

Product Specifications:

**84" Flexible Stainless Steel Hose w/ Black Handle & Polyurethane Inner Hose**

Product Compliance:

ASME A112.18.1 / CSA B125.1  
NSF 61 - Section 9  
NSF 372 (Low Lead Content)

equip  
Foodservice  
Accessories

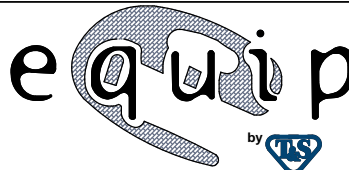

2 Saddleback Cove, P.O. Box 1088  
Travelers Rest, South Carolina 29690  
Phone: 800.891.4808 Fax: 800.868.0084  
equip.tsbrass.com