

**EASY TO INSTALL**

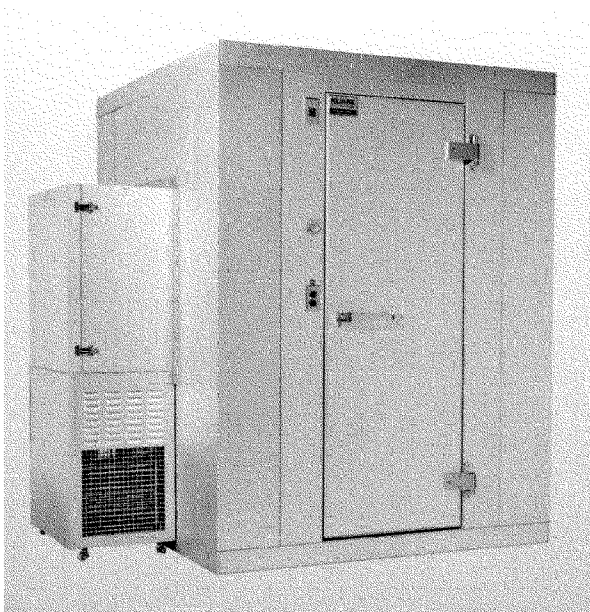
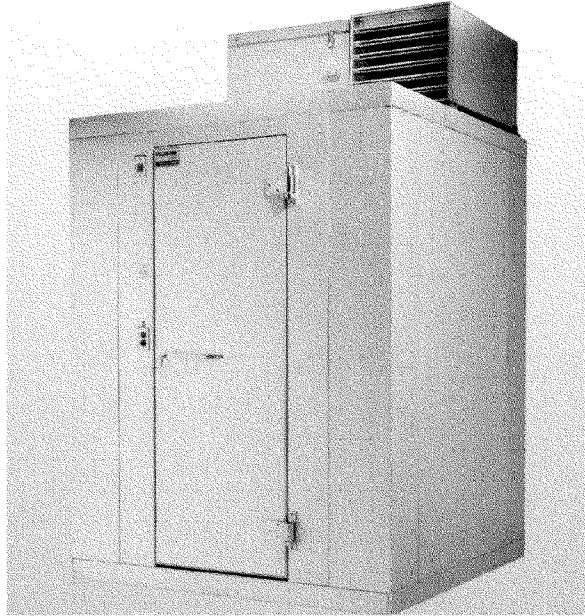

## 1 THE INDUSTRY'S SIMPLEST INSTALLATION.

Polar-Pak can easily be installed in practically no time at all without the services of a refrigeration technician or plumber.

Corners, wall panels and doors are quickly assembled on the unit's floor (or screeds), and the ceiling panels lifted into place. Then the self-contained wall-mount refrigeration unit, equipped with casters for leveling, is simply rolled up and fitted into place. The top mount system is shipped ready to fit into the appropriate ceiling panel, and is simply lifted into position and then bolted into place. Wiring the refrigeration system can be as simple as attaching a pigtail and plugging the unit into the wall. No drain line is required on indoor installations - making Polar-Pak ideal for basements and upper-floor applications.

Note: Outdoor Polar-Paks require drain lines (field supplied and installed).

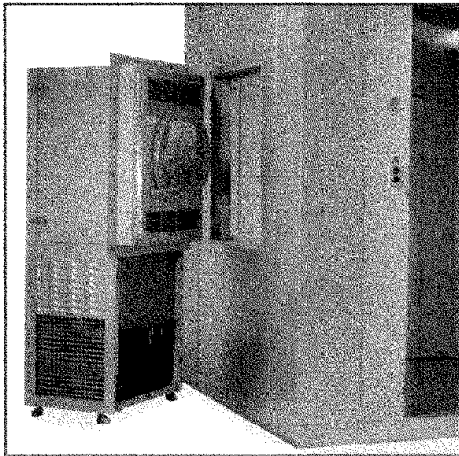

## 3 HOST OF INNOVATIVE STANDARD FEATURES

- Hot gas condensate evaporator.
- "Super Door" construction to seal in cold, prevent condensation.
- Posi-Loc panel fasteners for a perfect airtight fit.
- Brushed chrome hinges and door handle with key lock.
- Interior safety release to prevent accidental entrapment.
- Coved corners on floor panels for easier cleaning, greater sanitation.
- Heated air-vents on freezers to eliminate vacuum and pressure build-up.
- Vapor-proof interior light with convenient switch.

## 5 48-HOUR QUICK SHIP.

Some standard 7'6" high units are part of our Quick Ship program, and will ship within 48 hours after your order has been received. (see "QS" designation)

Orders specifying options will require standard lead times for shipping.

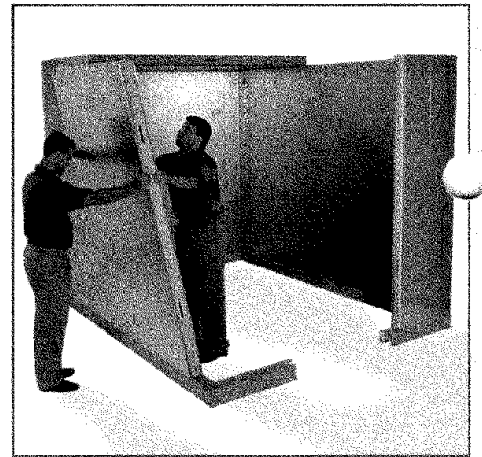

## 2 UNSURPASSED QUALITY

Polar-Pak coolers and freezers are made with the same rugged, high performance construction that has made KOLPAK the leader in walk in refrigeration.

The Polar-Pak modular panels of 4" 100% foamed in place non-CFC urethane foam offer superior insulating capabilities. The exterior and interior of top-quality galvalume offer an attractive and rugged metal finish. The Polar-Pak also offers superior air circulation around the coils making it both economical and efficient to run.



## 4 NO OTHER MANUFACTURER OFFERS YOU GREATER FLEXIBILITY

Polar-Pak is flexible enough to be used in virtually any configuration. There's no need for numbered panels. Side mount refrigeration systems can easily be set into any of the unit's 46" wide wall panel locations.

*Polar-Pak is the answer for your outdoor applications and is available in both top-mount and side-mount models. There are many more reasons to buy Polar-Pak coolers and freezers...*

KaTom Restaurant Supply, Inc.

FRONT

LEFT SIDE

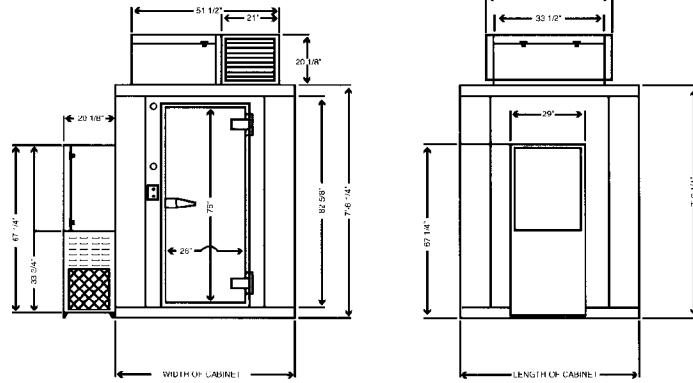

**Note:**  
Self-contained units require air circulation around refrigeration system.

Specifications subject to change without notice.

Key: ● Standard ○ Optional	Cooler	Freezer		Cooler	Freezer
Air cooled condensing units	●	●	Interior vapor proof light	●	●
Aluminum diamond tread plates (1/8", 3/16" or 1/4")	○	○	Keyed door locks	●	●
Automatic condensate evaporator	●	●	Kick plates (3' x 3')	○	○
Bumper rails and door bumpers	○	○	Low ambient controls	○	○
Combination construction	○	○	Magnetic door gaskets	●	●
Defrost timer	●	●	Membrane roof caps (side mount units)	○	○
Dial thermometer	●	●	Outdoor package	○	○
Door heater	●	●	NSF panels	●	●
Electric coil defrost system (indoor units)	●	●	Non-skid floor strips	○	○
Expansion valve systems	●	●	Off cycle coil defrost system	●	●
Exterior aluminum or stainless ramps (34" x 36")	○	○	Outdoor rain hoods	○	○
Fluorescent lights	○	○	Outside locking bar	○	○
Foam insulation (4")	●	●	Self closing door	●	●
Foamed in place panel gaskets	●	●	Shelving kits: three and four tier	○	○
Galvalume interior and exterior	●	●	Strip curtains	○	○
High pressure safety control	●	●	UL door section	●	●
Holding only refrigeration systems	●	●	UL panels (fire rated)	●	●
Inside safety release	●	●	1 year parts warranty	●	●
Interior .100" aluminum	●	●	10 year panel warranty	●	●
Interior galvanized ramps (34" x 20")	○	○	5 year compressor warranty	●	●
			1 year labor warranty	●	●

**With Floor**

**COOLERS: 38° F. - 7'6" High**

	Side Mount	Top Mount	Actual Size	Door Size	Capacity	Compressor	Amps	Electrical	Ship Weight
QS	P7-054-CS	P7-054-CT	4'10-1/2" x 3'11"	26" x 78"	84 cu. ft.	1/3 HP	12.6	115/60/1	779
QS	P7-064-CS	P7-064-CT	5'10" x 3'11"	26" x 78"	116 cu. ft.	1/3 HP	12.6	115/60/1	844
QS	P7-066-CS	P7-066-CT	5'10" x 5'10"	26" x 78"	184 cu. ft.	1/2 HP	14.7	115/60/1	1013
	P7-068-CS	P7-068-CT	5'10" x 7'9"	26" x 78"	252 cu. ft.	1/2 HP	14.7	115/60/1	1169
QS	P7-610-CS	P7-610-CT	5'10" x 9'8"	26" x 78"	320 cu. ft.	3/4 HP	21.6	*115/60/1	1368
QS	P7-612-CS	P7-612-CT	5'10" x 11'7"	26" x 78"	388 cu. ft.	3/4 HP	21.6	*115/60/1	1434
	P7-088-CS	P7-088-CT	7'9" x 7'9"	26" x 78"	345 cu. ft.	3/4 HP	21.6	*115/60/1	1391
	P7-810-CS	P7-810-CT	7'9" x 9'8"	26" x 78"	439 cu. ft.	3/4 HP	21.6	*115/60/1	1573
	P7-812-CS	P7-812-CT	7'9" x 11'7"	26" x 78"	532 cu. ft.	1 HP	18.9	**115/60/1	1762
	P7-108-CS	P7-108-CT	9'8" x 7'9"	26" x 78"	439 cu. ft.	3/4 HP	21.6	*115/60/1	1503
	P7-1010-CS	P7-1010-CT	9'8" x 9'8"	26" x 78"	558 cu. ft.	1 HP	18.9	**115/60/1	1790

**With Floor**

**FREEZERS 0° F. - 7'6" High**

	Side Mount	Top Mount	Actual Size	Door Size	Capacity	Compressor	Amps	Electrical	Ship Weight
QS	P7-054-FS	P7-054-FT	4'10-1/2" x 3'11"	26" x 78"	84 cu. ft.	3/4 HP	9.0	208-230/60/1	879
QS	P7-064-FS	P7-064-FT	5'10" x 3'11"	26" x 78"	116 cu. ft.	3/4 HP	9.0	208-230/60/1	944
QS	P7-066-FS	P7-066-FT	5'10" x 5'10"	26" x 78"	184 cu. ft.	1 HP	12.0	208-230/60/1	1113
QS	P7-068-FS	P7-068-FT	5'10" x 7'9"	26" x 78"	252 cu. ft.	1 HP	12.0	208-230/60/1	1269
	P7-610-FS	P7-610-FT	5'10" x 9'8"	26" x 78"	320 cu. ft.	1 3/4 HP	15.4	208-230/60/1	1433
	P7-612-FS	P7-612-FT	5'10" x 11'7"	26" x 78"	388 cu. ft.	1 3/4 HP	15.4	208-230/60/1	1524
QS	P7-088-FS	P7-088-FT	7'9" x 7'9"	26" x 78"	345 cu. ft.	1 3/4 HP	15.4	208-230/60/1	1456
QS	P7-810-FS	P7-810-FT	7'9" x 9'8"	26" x 78"	439 cu. ft.	1 3/4 HP	15.4	208-230/60/1	1638
	P7-812-FS	P7-812-FT	7'9" x 11'7"	26" x 78"	532 cu. ft.	1 3/4 HP	15.4	208-230/60/1	1762
	P7-108-FS	P7-108-FT	9'8" x 7'9"	26" x 78"	439 cu. ft.	1 3/4 HP	15.4	208-230/60/1	1503
	P7-1010-FS	P7-1010-FT	9'8" x 9'8"	26" x 78"	558 cu. ft.	1 3/4 HP	15.4	208-230/60/1	1790

QS = Available on the Kolpak Quick Ship program.

# Specifications:

**Interior Finish:** 26 gauge embossed galvalume  
**Exterior Finish:** 26 gauge embossed galvalume  
**Interior Floor:** .100" smooth aluminum  
**Insulation:** 4" 100% foam-in-place polyurethane  
**Thermometer:** 2 1/2" dial type

# Options & Accessories:

Cooler/freezer Combinations are available using listed compartment sizes. 30" and 34" wide doors. Contact factory for additional options and accessories.

## With Floor

### COOLERS: 38°F. - 6'6" High

Side Mount	Top Mount	Actual Size	Door Size	Capacity	Compressor	Amps	Electrical	Ship Weight
P6-054-CS	P6-054-CT	4'10-1/2" x 3'11"	26" x 66"	80 cu. ft.	1/3 HP	12.6	115/60/1	742
P6-064-CS	P6-064-CT	5'10" x 3'11"	26" x 66"	98 cu. ft.	1/3 IIP	12.6	115/60/1	803
P6-066-CS	P6-066-CT	5'10" x 5'10"	26" x 66"	156 cu. ft.	1/2 HP	14.7	115/60/1	965
P6-068-CS	P6-068-CT	5'10" x 7'9"	26" x 66"	213 cu. ft.	1/2 HP	14.7	115/60/1	1113
P6-610-CS	P6-610-CT	5'10" x 9'8"	26" x 66"	271 cu. ft.	3/4 HP	21.6	*115/60/1	1304
P6-612-CS	P6-612-CT	5'10" x 11'7"	26" x 66"	332 cu. ft.	3/4 HP	21.6	*115/60/1	1434
P6-088-CS	P6-088-CT	7'9" x 7'9"	26" x 66"	293 cu. ft.	3/4 HP	21.6	*115/60/1	1325
P6-810-CS	P6-810-CT	7'9" x 9'8"	26" x 66"	372 cu. ft.	3/4 HP	21.6	*115/60/1	1503
P6-812-CS	P6-812-CT	7'9" x 11'7"	26" x 66"	455 cu. ft.	1 HP	18.9	*115/60/1	1662
P6-108-CS	P6-108-CT	9'8" x 7'9"	26" x 66"	372 cu. ft.	3/4 HP	21.6	*115/60/1	1573
P6-1010-CS	P6-1010-CT	9'8" x 9'8"	26" x 66"	477 cu. ft.	1 HP	18.9	*115/60/1	1690

## With Floor

### FREEZERS 0°F. - 6'6" High

Side Mount	Top Mount	Actual Size	Door Size	Capacity	Compressor	Amps	Electrical	Ship Weight
P6-054-FS	P6-054-FT	4'10-1/2" x 3'11"	26" x 66"	80 cu. ft.	3/4 HP	9.0	208-230/60/1	842
P6-064-FS	P6-064-FT	5'10" x 3'11"	26" x 66"	98 cu. ft.	3/4 HP	9.0	208-230/60/1	903
P6-066-FS	P6-066-FT	5'10" x 5'10"	26" x 66"	156 cu. ft.	1 HP	12.0	208-230/60/1	1065
P6-068-FS	P6-068-FT	5'10" x 7'9"	26" x 66"	213 cu. ft.	1 HP	12.0	208-230/60/1	1213
P6-610-FS	P6-610-FT	5'10" x 9'8"	26" x 66"	271 cu. ft.	1 3/4 HP	15.4	208-230/60/1	1369
P6-612-FS	P6-612-FT	5'10" x 11'7"	26" x 66"	332 cu. ft.	1-3/4 HP	15.4	208-230/60/1	1434
P6-088-FS	P6-088-FT	7'9" x 7'9"	26" x 66"	293 cu. ft.	1 3/4 HP	15.4	208-230/60/1	1390
P6-810-FS	P6-810-FT	7'9" x 9'8"	26" x 66"	372 cu. ft.	1 3/4 HP	15.4	208-230/60/1	1568
P6-812-FS	P6-812-FT	7'9" x 11'7"	26" x 66"	455 cu. ft.	1 3/4 HP	15.4	208-230/60/1	1662
P6-108-FT	P6-108-FT	9'8" x 7'9"	26" x 66"	372 cu. ft.	1 3/4 HP	15.4	208-230/60/1	1573
P6-1010-FS	P6-1010-FT	9'8" x 9'8"	26" x 66"	477 cu. ft.	1 3/4 HP	15.4	208-230/60/1	1690

## Floorless

### COOLERS: 38°F - 6'6" High

Side Mount	Top Mount	Actual Size	Capacity	Compressor	Amps	Electrical	Ship Weight
PX6-054-CS	PX6-054-CT	4'10-1/2" x 3'11"	84 cu. ft.	1/2 HP	14.7	115/60/1	662
PX6-064-CS	PX6-064-CT	5'10" x 3'11"	104 cu. ft.	1/2 HP	14.7	115/60/1	707
PX6-066-CS	PX6-066-CT	5'10" x 5'10"	165 cu. ft.	3/4 HP	21.6	*115/60/1	821
PX6-068-CS	PX6-068-CT	5'10" x 7'9"	226 cu. ft.	3/4 IIP	21.6	*115/60/1	921
PX6-610-CS	PX6-610-CT	5'10" x 9'8"	287 cu. ft.	3/4 HP	21.6	*115/60/1	1064
PX6-612-CS	PX6-612-CT	5'10" x 11'7"	348 cu. ft.	3/4 HP	21.6	*115/60/1	1146
PX6-088-CS	PX6-088-CT	7'9" x 7'9"	309 cu. ft.	3/4 HP	21.6	*115/60/1	1067
PX6-810-CS	PX6-810-CT	7'9" x 9'8"	393 cu. ft.	1 HP	18.9	**115/60/1	1183
PX6-108-CS	PX6-108-CT	9'8" x 7'9"	393 cu. ft.	1 HP	18.9	**115/60/1	1183

Note: Add "R" or "L" to end of Model Numbers above to designate Right or Left Door Hinge.

## Floorless

### COOLERS: 38°F - 7'6" High

Side Mount	Top Mount	Actual Size	Capacity	Compressor	Amps	Electrical	Ship Weight
PX7-054-CS	PX7-054-CT	4'10-1/2" x 3'11"	98 cu. ft.	1/2 HP	14.7	115/60/1	699
PX7-064-CS	PX7-064-CT	5'10" x 3'11"	121 cu. ft.	1/2 HP	14.7	115/60/1	748
PX7-066-CS	PX7-066-CT	5'10" x 5'10"	192 cu. ft.	3/4 HP	21.6	*115/60/1	869
PX7-068-CS	PX7-068-CT	5'10" x 7'9"	264 cu. ft.	3/4 HP	21.6	*115/60/1	977
PX7-610-CS	PX7-610-CT	5'10" x 9'8"	335 cu. ft.	3/4 HP	21.6	*115/60/1	1128
PX7-612-CS	PX7-612-CT	5'10" x 11'7"	406 cu. ft.	3/4 HP	21.6	*115/60/1	1236
PX7-088-CS	PX7-088-CT	7'9" x 7'9"	360 cu. ft.	3/4 HP	21.6	*115/60/1	1135
PX7-810-CS	PX7-810-CT	7'9" x 9'8"	458 cu. ft.	1 IIP	18.9	**115/60/1	1253
PX7-108-CS	PX7-108-CT	9'8" x 7'9"	458 cu. ft.	1 HP	18.9	**115/60/1	1253

Note: Add "R" or "L" to end of Model Numbers above to designate Right or Left Door Hinge.

(\*Also available 208-230/60/11; \*Will run at 10.5 amps; \*\*Will run at 11.3 amps)