



BEVERAGE-AIR

| | |
|-----------------|------|
| Project: _____ | AIA# |
| Item: _____ | |
| Location: _____ | SIS# |
| Approved: _____ | |

FB27HC Bottom Mount Models: Vista Series

FB BOTTOM MOUNT REACH-IN FREEZER

FB27HC Solid Door Reach-in Freezer
Hydrocarbon Series

MODEL:

FB27HC-1S

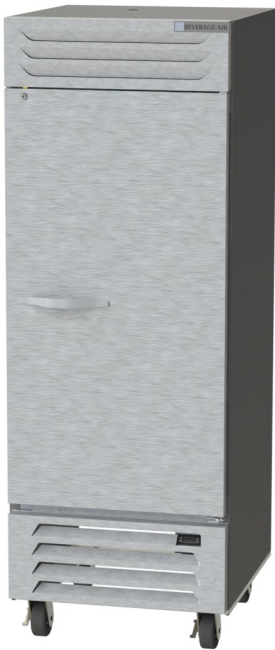

FB27HC

3 Year Parts/Labor Warranty
Additional 2 Year Compressor Warranty

CABINET CONSTRUCTION

- Stainless steel front, gray painted steel sides
- Gray painted interior
- Full electronic control
- Door locks standard
- LED lighting standard
- Anti-microbial door handles and door locks are standard
- Self-closing doors
- 120° stay open door feature
- One –piece grille allow easy removal/installation for preventative maintenance
- Cartridge style hinges
- Three (3) heavy duty epoxy coated wire shelves per section standard
- 6" Caster standard
- Maintains product temperatures to -15° F

OPTIONS & ACCESSORIES

- 3" casters or 6" legs
- Additional epoxy shelves
- Chrome plated shelves
- Universal stainless steel tray slides

REFRIGERATION SYSTEM

- Refrigeration system uses R290 refrigerant to comply with all environmental concerns
- Automatic, non-electric evaporator
- System is serviceable from rear
- Epoxy coated evaporator coil



3779 Champion Blvd., Winston-Salem, NC 27105
1-888-845-9800 Fax: 1-336-245-6453
Beverage-Air.com sales@bevair.com



BEVERAGE-AIR

Vista Series Bottom Mount Reach-in

Model: FB27HC-1S

| MODEL | FB27HC-1S |
|----------------------------------|-----------------------|
| EXTERNAL DIMENSIONAL DATA | |
| Width Overall | 30" |
| Depth Overall with Handle | 33 11/16" |
| Height Overall (6" casters) | 84" |
| Number of Doors | 1 |
| Depth with Door Open 90° | 60" |
| Drawer Opening (inches) | 27 13/16" x 52 37/64" |
| INTERNAL DIMENSIONAL DATA | |
| NET Capacity (cubic ft.) | 25.5" |
| Internal Width Overall (inches) | 27 7/64" |
| Internal Depth Overall (inches) | 28 1/2" |
| Internal Height Overall—(inches) | 53" |
| Number of shelves | 3 |
| ELECTRICAL DATA | |
| Full Load Amperes 115/60/1 | 8.0 |
| REFRIGERATION DATA | |
| Horsepower | 3/4 |
| WEIGHT DATA | |
| Gross Weight (Crated lbs) | 412 lbs |
| Height - Crated | 85" |
| Width - Crated | 32" |
| Depth - Crated | 36" |

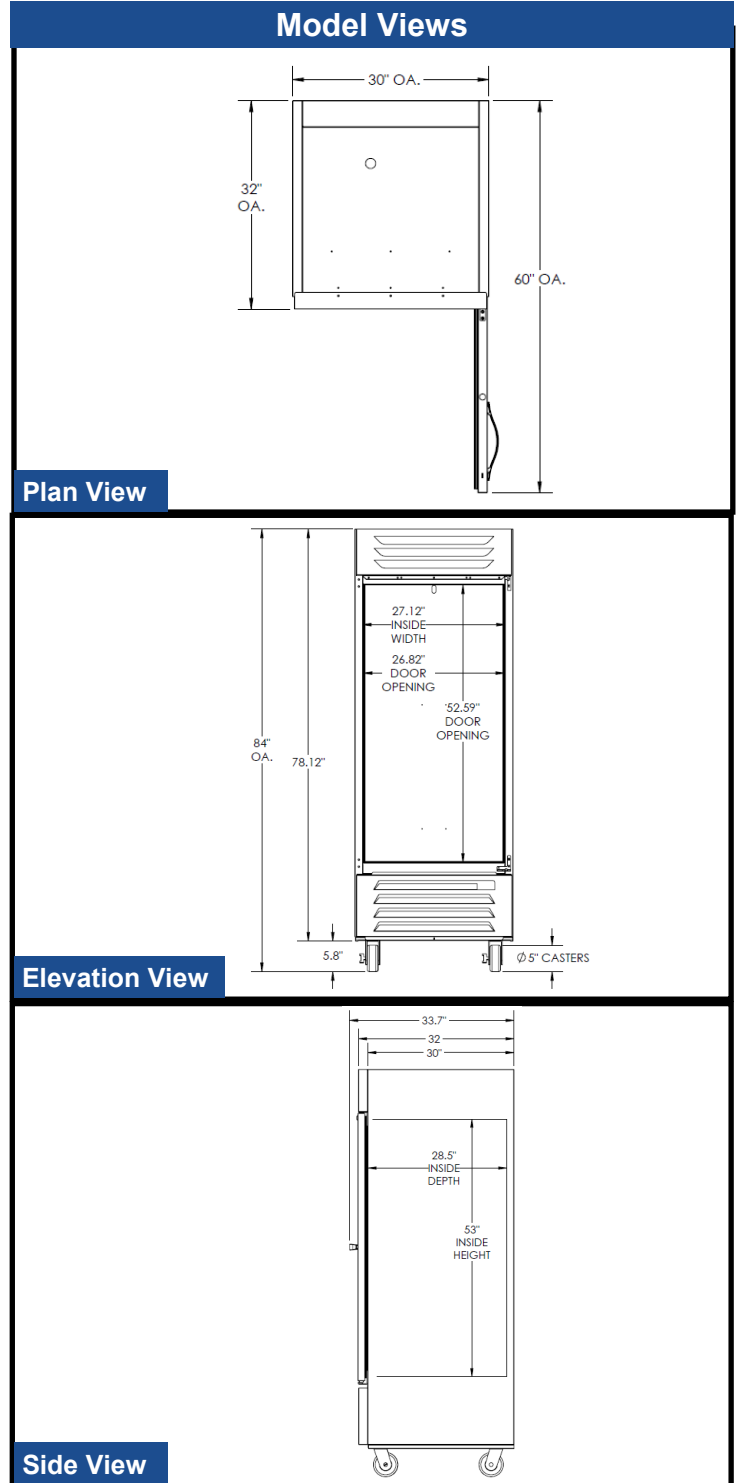

ELECTRICAL CONNECTION

Units pre-wired at factory and include 8' long cord and plug set.



115/60/1
NEMA-5-15P



an Ali Group Company



The Spirit of Excellence

3779 Champion Blvd., Winston-Salem, NC 27105
1-888-845-9800 Fax: 1-336-245-6453
Beverage-Air.com sales@bevair.com