

BL & BA Series Pourover Brewers



Model BA-P
(Airpot sold separately)



Model BL-2P
(Decanters sold separately)



Model BL-3PW
(Decanters sold separately)



GRINDMASTER™
CORPORATION



GRINDMASTER™

CORPORATION

BL & BA Series Pourover Brewers

Features

- Space-saving designs
- Attractive appearance styled to complement any decor
- Durable stainless steel construction
- Front pour-in basin conveniently located on top front of machine
- Plastic brew basket

BA-P Features

- Brews directly into airpot (airpot sold separately)
- Space-saving front to back design - 8-1/2" (22 cm) wide

BL-2P Features

- 2 warmers for a variety of coffee types and flavors
- Lighted warmer switches indicate when warmers are "On"
- Space-saving front to back design - 8-1/2" (22 cm) wide

BL-3PW Features

- 3 warmers for a variety of coffee types and flavors
- Lighted warmer switches indicate when warmers are "On"
- Low profile - only 16-1/2" (42 cm) tall to fit under standard cabinets

Model
BA-P

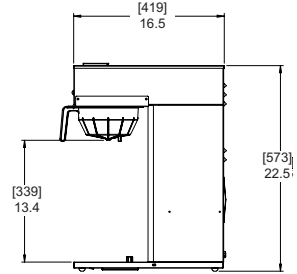
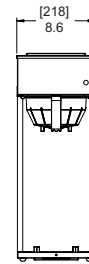

Model
BL-2P

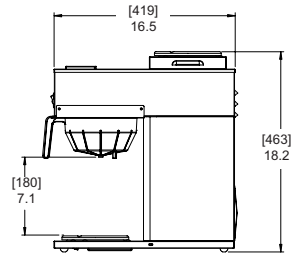
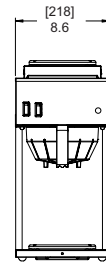

Model
BL-3PW

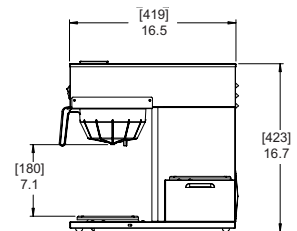
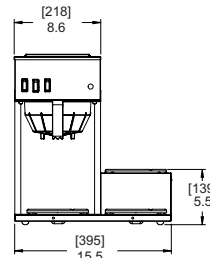

Specifications	Model BA-P / BA-PE	Model BL-2P / BL-2PE	Model BL-3PW / BL-3PWE
Volts/Watts/Amps	BA-P: 120V / 1400W / 11.7A BA-PE: 230V / 2300W / 10 A, 50/60 Hz	BL-2P: 120V / 1600W / 13.3A BL-2PE: 230V / 2520W / 11A, 50/60 Hz	BL-3PW: 120V / 1700W / 14.2A BL-3PWE: 230V / 2630W / 11.4A, 50/60 Hz
Brew Capacity	1/2 Gallon (1.9 L)	1/2 Gallon (1.9 L)	1/2 Gallon (1.9 L)
# Warmers	0	2	3
Dimensions (H x W x D)	22-1/2" H x 8-1/2" W x 16-1/2" D (57 cm x 22 cm x 42 cm)	17-3/4" H x 8-1/2" W x 16-1/2" D (45 cm x 22 cm x 42 cm)	16-1/2" H x 15-1/2" W x 16-1/2" D (42 cm x 40 cm x 42 cm)
Ship Dimensions (H x W x D)	26-1/4" H x 15" W x 26-1/4" D (67 cm x 38 cm x 67 cm)	21-1/2" H x 15" W x 26-1/4" D (67 cm x 38 cm x 67 cm)	21-1/2" H x 21-1/4" W x 20-1/4" D (55 cm x 54 cm x 67 cm)
Ship Weight	27 lbs (12.3 kg)	27 lbs (12.3 kg)	31 lbs. (14 kg)
Listings	UL, NSF, (CE for E models only)	UL, NSF, (CE for E models only)	UL, NSF, (CE for E models only)

All specifications are subject to improvement or change without notice.

Ask about Grindmaster Corporation's line of Coffee Grinders, Coffee Brewers, Coffee Urns, Coffee Shuttles, Coffee Grindbrewers, Espresso Grinders, Espresso Brewers, Beverage Dispensers Granita Machines and Beverage Freezers.



GRINDMASTER™

CORPORATION



Grindmaster® Coffee Grinders and Brewers • Espresso® Espresso Machines • Crathco® Hot Beverage Dispensers
Crathco® Cold and Frozen Beverage Dispensers • American Metal Ware® Coffee and Tea Systems
Tel (502) 425-4776 • Fax (502) 425-4664 • 1-800-695-4500 (USA & Canada only)

P.O. Box 35020 • Louisville, KY 40232 • USA