



EMPower Ambient Stainless Steel Worktop - 12"

ITEM # _____

MODEL # _____

NAME # _____

SIS # _____

AIA # _____



EMPower

Ambient Stainless Steel Worktop - 12"

169153 (AN12)

EMPower Restaurant Range worktop, ambient, 12", stainless steel construction, may be installed on refrigerated base or open cupboard

Short Form Specification

Item No. _____

EMPower unit to be Electrolux Ambient Worktop 12" (305 mm). Construction in AISI 304 Stainless Steel. Right-angled side edges to allow flush fitting between EMPower units. Supplied with 6" (150 mm) height adjustable, removable legs.

Main Features

- Unit may be installed on refrigerated base or open cupboard.
- Front and side panels in Stainless Steel with Scotch Brite finish.
- Right-angled side edges to allow flush fitting joints between units, eliminating gaps and possible dirt traps.
- Provided with kit for side-by-side connection between units for minimizing gaps and possible dirt traps.
- Unit may be installed on refrigerated base by inserting the special pins (optional accessory).
- Unit may be installed on open cupboard by inserting the screws provided as standard with the open cupboards.
- Unit is 12" (305 mm) wide to provide a larger working surface.

Construction

- Worktop in 304 AISI stainless steel.
- 4 screws to install on the cupboard base are supplied with the unit.

Optional Accessories

- EMPower 4 pins kit for mounting unit PNC 169048 to refrigerated/freezer. 1 kit is supplied with each EMPower refrigerated base
- EMPower back mounted rear shelf-spacer, 12"unit PNC 169096
- Portioning Shelf 12" PNC 169173

APPROVAL: _____

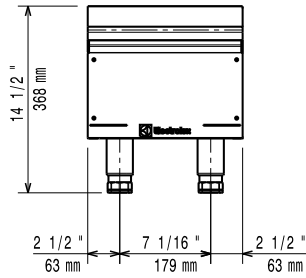
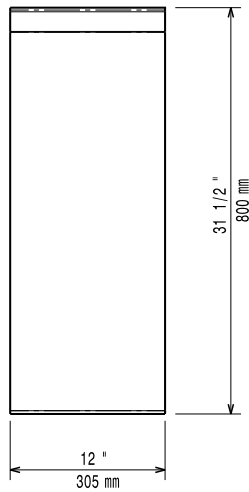

Front

Top

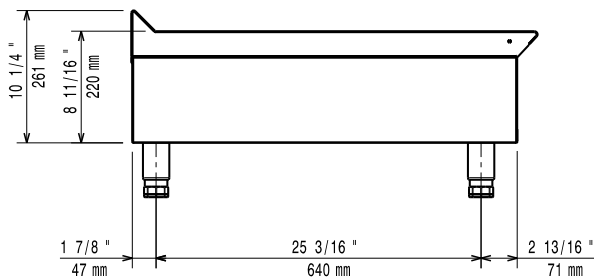
EQ = Equipotential screw

Side

Key Information:

| | |
|-------------------------------------|---|
| External dimensions, Width: | |
| 169153 (AN12) | 12 1/64" (305 mm) |
| External dimensions, Depth: | 31 1/2" (800 mm) |
| External dimensions, Height: | 14 1/2" (368 mm) |
| Net weight: | 26 lbs (12 kg) |
| Shipping width: | 14 9/16" (370 mm) |
| Shipping depth: | 36 1/32" (915 mm) |
| Shipping height: | 25 " (635 mm) |
| Shipping weight: | 31 lbs (14 kg) |
| Shipping volume: | 7.59 ft ³ (0.21 m ³) |