

Enhanced Functionality



All High Heat Food Pans are safe for cooking applications up to 375°F (190°C).

High Heat X-Pan®



High Heat H-Pan™



High Heat H-Pan™

- Ideal for use in microwaves, steam tables, ovens and hot holding applications.
- Reduce unnecessary handling – high heat food pans can go from prep, to cooler, to oven to hot holding applications at temperatures ranging from -40° to 375°F (-40° to 190°C).
- High Heat Food Pans are safe for use in high-temp commercial dishwashers.

CAMBRO
TRUSTED FOR GENERATIONS™

Enhanced Functionality

Cambro® High Heat Food Pans withstand and adapt to different temperatures cold to hot, thus expanding functionality and reducing unnecessary handling.



FULL SIZE

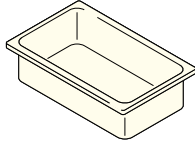

*HALF SIZE LONG

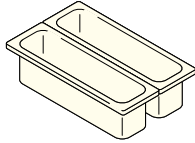

HALF SIZE

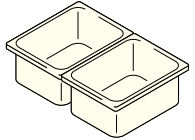

ONE THIRD SIZE

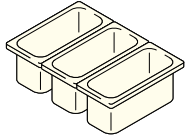

QUARTER SIZE

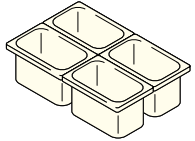

ONE SIXTH SIZE

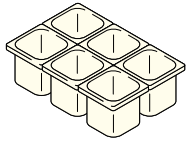

ONE EIGHTH SIZE

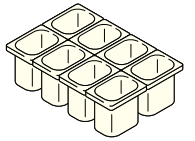

*ONE NINTH SIZE

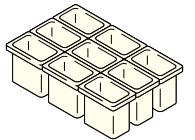

CONFIGURATIONS	PAN CODE	PAN DEPTH	APPROXIMATE CAPACITY	LIST PRICE EA.
1/1 12 ³ / ₄ " x 20 ⁷ / ₈ " (32,5 x 53 cm)	12HP	2 ¹ / ₂ " (6,5 cm)	8.9 qt.	\$ 64.10
	14HP	4" (10)	13.7	77.55
	16HP	6" (15)	20.6	100.80
	13CLRHP	3" (7,6 cm)	Colander Pan	77.55
	15CLRHP	5" (12,7)	Colander Pan	100.80
	10HPD	—	Drain shelf	42.45
1/2 Long* 6 ³ / ₈ " x 20 ⁷ / ₈ " (16,2 x 53 cm)	22LPH	2 ¹ / ₂ " (6,5)	3.2	45.60
	24LPH	4" (10)	5.3	56.70
	20LPHPD	—	Drain shelf	21.20
1/2 10 ¹ / ₁₆ " x 12 ³ / ₄ " (26,5 x 32,5 cm)	22HP	2 ¹ / ₂ " (6,5)	4.1	31.95
	24HP	4" (10)	6.3	41.55
	26HP	6" (15)	9.4	53.25
	23CLRHP	3" (7,6 cm)	Colander Pan	41.55
	25CLRHP	5" (12,7)	Colander Pan	53.25
	20HPD	—	Drain shelf	19.05
1/3 6 ¹ / ₁₆ " x 12 ³ / ₄ " (17,6 x 32,5 cm)	32HP	2 ¹ / ₂ " (6,5)	2.5	26.75
	34HP	4" (10)	3.8	34.65
	36HP	6" (15)	5.6	47.15
	33CLRHP	3" (7,6 cm)	Colander Pan	34.65
	35CLRHP	5" (12,7)	Colander Pan	47.15
	30HPD	—	Drain shelf	14.30
1/4 6 ¹ / ₁₆ " x 10 ⁷ / ₁₆ " (16,2 x 26,5 cm)	42HP	2 ¹ / ₂ " (6,5)	1.8	23.15
	44HP	4" (10)	2.7	28.60
	46HP	6" (15)	3.9	36.65
	40HPD	—	Drain shelf	14.30
1/6 6 ³ / ₈ " x 6 ¹⁵ / ₁₆ " (16,2 x 17,6 cm)	62HP	2 ¹ / ₂ " (6,5)	1.1	18.10
	64HP	4" (10)	1.6	21.85
	66HP	6" (15)	2.4	26.50
	63CLRHP	3" (7,6 cm)	Colander Pan	21.85
	65CLRHP	5" (12,7)	Colander Pan	26.50
	60HPD	—	Drain shelf	7.35
1/8 6 ⁵ / ₁₆ " x 5 ³ / ₁₆ " (16,12 x 13,17 cm)	82HP*	2 ¹ / ₂ " (6,5)	0.7	15.85
	84HP*	4" (10)	1.1	20.05
	86HP*	6" (15)	1.5	25.85
	80HPD*	—	Drain shelf	6.45
1/9 4 ¹ / ₄ " x 6 ¹⁵ / ₁₆ " (10,8 x 17,6 cm)	92HP	2 ¹ / ₂ " (6,5)	0.6	13.70
	94HP	4" (10)	0.9	16.00
	96PH*	6" (15)	1.4	22.75
	90HPD	—	Drain shelf	5.45

Case Pack: 6

Color: Amber (150), Black (110), Sandstone (772).

Drain Shelf and Colander Color: Amber (150).

*Not Available in Sandstone (772)

Drain Shelves



Lifts contents out of liquids to enhance food quality and freshness. Available to fit all pan sizes.

Colander Pans

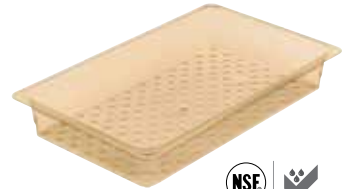

Liquids drain away from food into the pan below for enhanced food quality and improved food safety.



Steam



Hold Hot Foods



Drain

For more information about Cambro products visit www.cambro.com or contact your Distributor, Cambro Sales Representative or the Cambro Customer Service Department.



High Heat Food Pan Lids



Flat Cover

Available in all pan sizes.



FITS PAN	LID CODE	DESCRIPTION	LIST PRICE EA.
GN 1/1 12 ³ / ₄ " x 20 ⁷ / ₈ " (32,5 x 53 cm)	10HPC	Flat cover	\$ 57.55
	10HPCH	Cover with handle	57.55
	10HPCHN	Notched cover w/ handle	57.60
	10CWGL	GripLid	37.95

Cover with Handle

Deep molded handle gives secure grip.



GN 1/2 Long 6 ³ / ₈ " x 20 ⁷ / ₈ " (16,2 x 53 cm)	20LPHPC	Flat cover	34.35
---	---------	------------	-------

GN 1/2 10 ¹ / ₁₆ " x 12 ³ / ₄ " (26,5 x 32,5 cm)	20HPC	Flat cover	25.05
	20HPCH	Cover with handle	26.55
	20HPCHN	Notched cover w/ handle	30.45
	20HPL	FlipLid	44.10
	20HPLN	Notched FlipLid	44.10
	20CWGL	GripLid	26.35

Notched Cover with Handle

Easy access for ladles or spoons.



GN 1/3 6 ¹⁵ / ₁₆ " x 12 ³ / ₄ " (17,6 x 32,5 cm)	30HPC	Flat cover	18.70
	30HPCH	Cover with handle	21.10
	30HPCHN	Notched cover w/ handle	21.10
	30HPL	FlipLid	31.50
	30HPLN	Notched FlipLid	31.50
	30CWGL	GripLid	18.15

FlipLid®

Flip up lid to easily access contents. Food can be held without getting dried out, increasing yields.



GN 1/4 6 ³ / ₈ " x 10 ¹ / ₁₆ " (16,2 x 26,5 cm)	40HPC	Flat cover	15.20
	40HPCH	Cover with handle	16.35
	40HPCHN	Notched cover w/ handle	16.55

GN 1/6 6 ³ / ₈ " x 6 ¹⁵ / ₁₆ " (16,2 x 17,6 cm)	60HPC	Flat cover	13.25
	60HPCH	Cover with handle	13.25
	60HPCHN	Notched cover w/ handle	13.25
	60HPL	FlipLid	18.05
	60HPLN	Notched FlipLid	18.05
	60CWGL	GripLid	14.90

Notched FlipLid®

FlipLid with notch to rest spoon in contents with lid closed.



GN 1/8 6 ¹ / ₁₆ " x 5 ³ / ₁₆ " (16,12 x 13,17 cm)	80HPC	Flat cover	11.15
	80HPCH	Cover with handle	11.15
	80HPCHN	Notched cover w/ handle	11.15

GripLid®

Molded-in polyurethane gasket on the lid grips the side of the food pan, reducing spills and points of cross-contamination.



GN 1/9 4 ¹ / ₄ " x 6 ¹⁵ / ₁₆ " (10,8 x 17,6 cm)	90HPC	Flat cover	9.10
---	-------	------------	------

Case Pack for all Lids: 6 Color: Amber (150).
GripLid Color: Clear (135).



High Heat H-Pan™ with Handle(s)



H-Pan with Handles (1/3 Size Pan)

- Flat base to maximize contact with heating element.
- Fits all leading manufacturer's Product Holding Units (PHU), including single-sided and pass-through models.
- High Heat Material withstands temperatures from -40° to 375°F (-40° to 190°C).
- Drain shelves lift contents out of liquids to enhance food quality and freshness.
- Reinforced textured handle design with finger grip feature for a secure grasp.
- Handle designed with drain holes to avoid water build-up after warewashing process.



32HP1H



32HP2H

CONFIGURATIONS	PAN CODE	DESCRIPTION	PAN DEPTH	APPROX. CAPACITY	LIST PRICE EA.
1/3 6 ¹⁵ / ₁₆ " x 12 ³ / ₄ " (17,6 x 32,5 cm)	32HP1H	Single Handle	2 ¹ / ₂ " (6,5 cm)	2.5 qt.	\$ 41.00
	32HP2H	Double Handle	2 ¹ / ₂ " (6,5)	2.5	42.00
	30HPD	Drain shelf	—	—	14.30

Case Pack: 6 **Color:** Amber (150).

Dimensions are for pans only. Does not include handle dimensions.

H-Pan with Handles (Full Size Pan)

- Full size 2¹/₂" deep food pan with handles fits all leading manufacturers' Product Holding Units..
- High Heat Material withstands temperatures from -40° to 375°F (-40° to 190°C).
- Two handles allow employees to reach the pan from either side of the unit for safe handling.
- Drain shelves lift contents out of liquids to enhance food quality and freshness.



12HPH

CONFIGURATIONS	PAN CODE	PAN DEPTH	APPROX. CAPACITY	LIST PRICE EA.
1/1 12 ³ / ₄ " x 20 ⁵ / ₈ " (32,5 x 53 cm)	12HPH	2 ¹ / ₂ " (6,5 cm)	8.9 qt.	\$ 73.70
	10HPD	—	Drain shelf	42.45

Case Pack: 6 **Color:** Amber (150).

Drains listed on previous page.

