

H-PAN™ HIGH HEAT FOOD PANS

Reduce handling and save expense with one pan that can go from prep to cooler to oven to steam table. H-Pans are designed to Gastronorm GN specifications. Unlike metal pans, H-Pans are safe for use in heating and holding applications. Ideal for heated carts, steam tables and chafing dishes. H-Pans have both standard and metric graduation markings to promote easy inventory management.

Colors: Amber (150), Black (110).
Drain Shelf Color: Amber (150).

H-Pans are made of FDA approved material and are designed to CEN Gastronorm Standard EN 631-1. Amber color may vary.

Microwave safe.



Uniform 1/2" (1,27 cm) flange ensures a smooth fit in prep tables and food bars.

Cool to the touch for easy handling.

Great for flash freezing and reheating.

Pans stack neatly, without wedging or sticking.



Made from FDA approved material that withstands temperatures from -40° to 375°F (-40° to 190°C).

Non-stick smooth interior surface increases yields and promotes easy cleaning.



H-PAN™ HIGH HEAT FOOD PANS



FULL SIZE

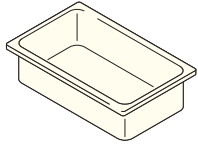

CONFIGURATIONS	PAN CODE	PAN DEPTH	APPROXIMATE CAPACITY	LIST PRICE EA.
GN 1/1 12¾" x 20⅞" (32,5 x 53 cm)	12HP	2½" (6,5 cm)	8.9 qt.	\$ 64.10
	14HP	4" (10)	13.7	77.55
	16HP	6" (15)	20.6	100.80
	10HPD	—	Drain shelf	42.45

Colors: Amber (150), Black (110).
Drain Shelf Color: Amber (150).

H-Pans are made of FDA approved material and are designed to CEN Gastronorm Standard EN 631-1. Amber color may vary.

Microwave safe.



HALF SIZE LONG

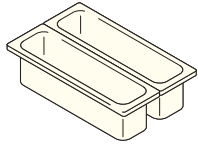

GN 1/2 Long 6⅞" x 20⅞" (16,2 x 53 cm)	22LPHP	2½" (6,5)	3.2	45.60
	24LPHP	4" (10)	5.3	56.70
	20LPHPD	—	Drain shelf	21.20

HALF SIZE

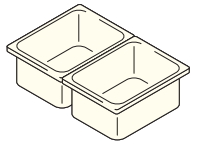

GN 1/2 10⅞" x 12¾" (26,5 x 32,5 cm)	22HP	2½" (6,5)	4.1	31.95
	24HP	4" (10)	6.3	41.55
	26HP	6" (15)	9.4	53.25
	20HPD	—	Drain shelf	19.05

Drain Shelf

- Supports product and promotes drainage.
- Available to fit all food pan sizes.

ONE THIRD SIZE

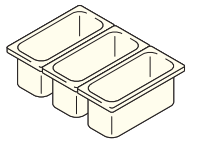

GN 1/3 6⅞" x 12¾" (17,6 x 32,5 cm)	32HP	2½" (6,5)	2.5	26.75
	34HP	4" (10)	3.8	34.65
	36HP	6" (15)	5.6	47.15
	30HPD	—	Drain shelf	14.30

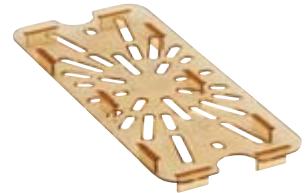

QUARTER SIZE

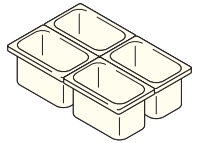

GN 1/4 6⅞" x 10⅞" (16,2 x 26,5 cm)	42HP	2½" (6,5)	1.8	23.15
	44HP	4" (10)	2.7	28.60
	46HP	6" (15)	3.9	36.65
	40HPD	—	Drain shelf	14.30



ONE SIXTH SIZE

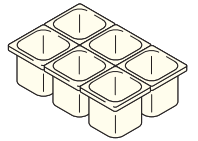

GN 1/6 6⅞" x 6⅞" (16,2 x 17,6 cm)	62HP	2½" (6,5)	1.1	18.10
	64HP	4" (10)	1.6	21.85
	66HP	6" (15)	2.4	26.50
	60HPD	—	Drain shelf	7.35

ONE EIGHTH SIZE

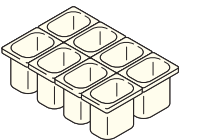

GN 1/8 6⅞" x 5⅞" (16,12 x 13,17 cm)	82HP	2½" (6,5)	0.7	15.85
	84HP	4" (10)	1.1	20.05
	86HP	6" (15)	1.5	25.85
	80HPD	—	Drain shelf	6.45



86HP
Shown with Optional Drain Shelf.

ONE NINTH SIZE

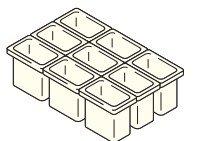

GN 1/9 4¼" x 6⅞" (10,8 x 17,6 cm)	92HP	2½" (6,5)	0.6	13.70
	94HP	4" (10)	0.9	16.00
	96PHP	6" (15)	1.4	22.75
	90HPD	—	Drain shelf	5.45

Case Pack: 6 InStock Color: Amber (150).