

SCF1076GDC

48.5" x 42.63" x 27.0" (H x W x D)

Deluxe dipping cabinet complete with glass sneezeguard, light, digital thermostat, and three interior baskets on flat top commercial ice cream freezer

Highlights:

Deluxe dipping cabinet with tempered glass sneezeguard and fluorescent lighting

Commercially listed for foodservice use

Choice of gelato pans, ice cream tub holders, or novelty baskets

Factory installed lock on sliding glass lids



Tempered glass sneezeguard	Durable sneezeguard with stainless steel worktop
Fluorescent light	Fully illuminates products for a tempting display
Digital thermostat	Set precise serving temperature with easy electronic controls
Caster wheels	Heavy duty casters for smooth mobility
Fan-cooled compressor	Interior maintains even cooling so all contents stay cold
Manual defrost	Front located drain for easy defrosting
Factory installed lock	Keyed lock for secure interior
Hammered aluminum interior	21" deep for maximum storage
Choice of storage accessories	Choose 2 gelato pan holders or 3 ice cream tub holders
Fully assembled	Product ships fully assembled and ready to use

Specifications:

Height	48.5"
Width	42.63"
Depth	27.0"
Capacity	10.6 cu.ft.
Interior Height 1	25.63"
Interior Width 1	42.63"
Interior Depth 1	20.88"
Comp Step Height	10.5"
Comp Step Width	12.25"
Amps	3.3
Voltage/Frequency	115 V AC/60 Hz
US Electrical Safety	ETL
Door Swing	Sliding
Wheel Quantity	4
Defrost Type	Manual
Light	true
Thermostat Type	Digital
Freon Type	R134a
High Side PSI	250.0
Freon Oz	4.9
Low Side PSI	88.0
Compressor Warranty	5 Years
Parts/Labor Warranty	1 Year
Sanitation	ETL-S

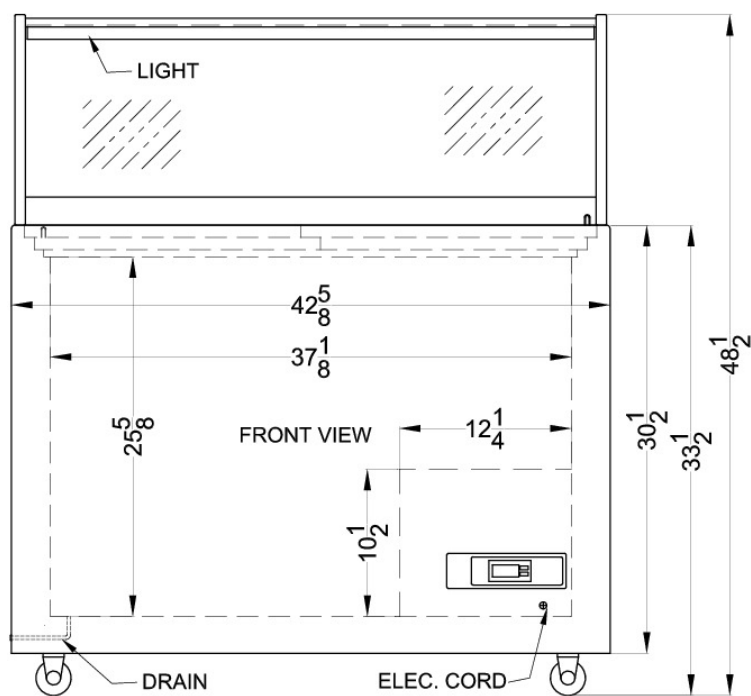
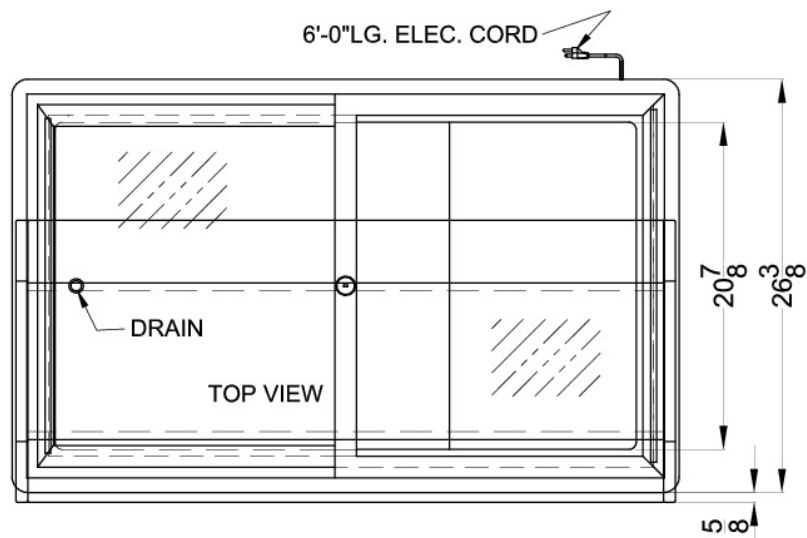

Summit Appliance Division, Felix Storch, Inc.
 770 Garrison Ave • Bronx, NY 10474
 Phone: 718-893-3900 • Fax: 718-842-3093
 Email: info@summitappliance.com