



**Model PCF14 and PCF18  
Crisp N' Hold Food Cabinet  
Station**  
*(Forced Hot Air Holding System)*

Project \_\_\_\_\_  
Item No. \_\_\_\_\_  
Quantity \_\_\_\_\_

Model PCF14 and PCF18 Crisp N' Hold Food Cabinet Station

**APPLICATION**

The Crisp N' Hold Food Station extends the holding time of fried food by maintaining a constant flow of heated air in and around the product. The air is filtered, re-circulated and incrementally heated to control the accumulation of moisture, conserve energy and keep food warm and crisp.



**STANDARD SPECIFICATIONS**

**CONSTRUCTION**

- Pan area allows for holding and draining of finished product.
- Food Grate easily lifts out for cleaning.
- Bottom Shelf provides ample storage for breading, batter, food utensils, etc.  
*\*Bottom Shelf is not provided when a filter pump or flush hose is located inside the dump station.*
- Stainless steel front, sides, door and splash back.
- Stainless steel Food Bay.
- Heavy Duty 3/16" (.48 cm) door hinge.
- Designed to match existing or accompanying Solstice fryers.
- Unit can be installed on either side or between solstice fryer(s).

**HEATING SYSTEM**

Provides a stream of constant circulation of warm air to maintain crispy food, serving temperatures, and extend holding times.

**AVAILABLE OPTIONS & ACCESSORIES**

(at additional cost)

- 9" (22.9cm) Casters



**STANDARD FEATURES**

- Removable Product Dividers –  
PCF14 - Qty 1  
PCF18 - Qty 2
- Collection pan pulls out for cleaning
- 9" (22.9cm) adjustable legs, easier access to clean
- Bottom Shelf
- Digital temperature control behind door

**OPERATIONS**

- Easily integrates into existing Solstice fryer combinations to provide a comfortable work area or food preparation station.
- Removable Filter traps oils & are Dishwasher safe



# Model PCF14 and PCF18 Crisp N' Hold Food Cabinet Station

Model PCF14 and PCF18 Crisp N' Hold Food Cabinet Station

MODEL	DIM A	DIM B
PCF14	15 5/8" [39.7]	12 3/4 [32.5]
PCF18	19 5/8" [49.8]	16 3/4 [42.5]

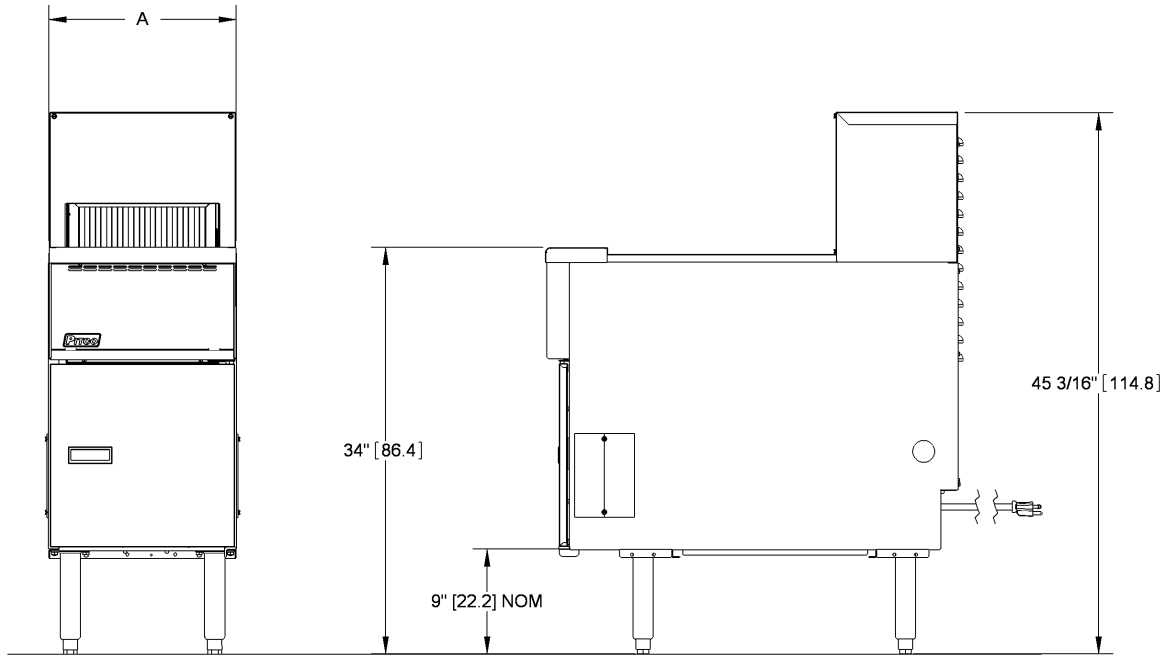
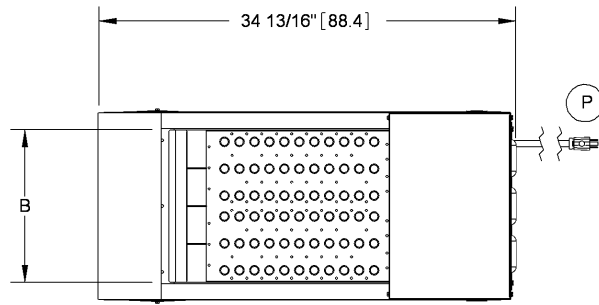

(P) = 6 FOOT [187cm] POWER CORD (NEMA 5-20P PLUG)

## ORDERING INFORMATION

Specify model number of fryers desired and placement of dump station.  
PCF14 or PCF18 model number indicates dump station for use with gas/electric cooking systems only.  
For use with Solstice gas/electric fryers.

## SHORT FORM SPECIFICATION

Provide Pitco Model PCF14 or PCF18 Crisp N' Hold Crispy Food Station. Unit shall be a one piece cabinet to match the dimensions of existing or new SG/SE Gas/Electric equipment. Crisp N' Hold Crispy Food Station shall be supplied with a collection pan, food grate and bottom shelf.

## ELECTRICAL

PCF14 or PCF18      120 Volts 1820 watts, 15.1 amps, 60 hz single phase

## TYPICAL APPLICATION

Provide a warming and holding area for finished products. Capable of heating to 190°F (88°C). Preheat to 190°F (88°C) in approximately 10 minutes.

## SHIPPING INFORMATION (Approximate)

Model	Shipping Weight	Shipping H x W x L	Shipping Cube
PCF14	150.0 lb (68.0 kg)	45.0 x 19.0 x 36.0 in (114.3 x 48.3 x 91.4 cm)	17.8 ft <sup>3</sup> (0.5 m <sup>3</sup> )
PCF18	175.0 lb (79.4 kg)	45 x 23 x 38 in ( 88.9 x 58.4 x 96.5 cm)	22.8 ft <sup>3</sup> (0.6 m <sup>3</sup> )



Pitco Frialator, Inc • P.O. Box 501, Concord, NH 03302-0501 • 509 Route 3A, Bow, NH 03304

603-225-6684 • FAX: 603-225-8497 [www.pitco.com](http://www.pitco.com) L10-346 Rev 2 06/10 Printed in the USA

We reserve the right to change specifications without notice and without incurring any obligation for equipment previously or subsequently sold.