

# FOOD SERVICE SERIES

## Reach In Uprights

### Features

- ▶ Reversible door on single door models
- ▶ Interior lighting
- ▶ Safety door lock and keys
- ▶ Forced air system with manual temp control
- ▶ Optional 6" legs

### Hardware & Construction

- ▶ Stainless steel series 430 exterior doors, fronts & sides
- ▶ Stainless steel series 304 interior doors, sides & flooring
- ▶ Stucco aluminum back panel
- ▶ Thick 2.5" foamed in place polyurethane insulation

### Door / Lid System

- ▶ Self closing hinged doors with 90° stay open feature
- ▶ Recessed handle on front of door

### Temperature

- ▶ LED digital temperature display
- ▶ Temperature range / refrigerator: 32° to 50°F
- ▶ Temperature range / freezer: 0 to -8°F

### Shelving / Baskets / Dividers

- ▶ Plastic coated adjustable steel shelves with clips

### Standard

- ▶ Automatic defrost by thermostat cycle
- ▶ Removable door gasket to facilitate cleaning
- ▶ Round corners at bottom interior for sanitation needs
- ▶ 5" industrial casters / front 2 locking
- ▶ Refrigerant CFC-free R-134a
- ▶ 8-ft power cord and plug set

### Models

- CFD1RR-23       CFD1FF-23
- CFD2RR-48       CFD2FF-48
- CFD3RR-72       CFD3FF-72



CFD1RR-23  
 CFD1FF-23  
 Reversible Door



CFD2RR-48  
 CFD2FF-48



CFD3RR-72  
 CFD3FF-72

NOTE: Cabinet designed for optimum performance in climate controlled area at 85°F ambient and 55% relative humidity

#### WARRANTY

18 Months Parts and Labor  
 5 Years Compressor (part only)  
 Administered by:  
 Metalfrío Solutions 888-403-0070 TF  
 (U.S.A. Only)

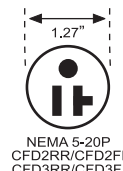
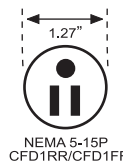

Product design and specifications are subject to modification by manufacturer without prior notice.

# FOOD SERVICE SERIES

## Reach In Uprights

### Models

- ☐ CFD1RR-23      ☐ CFD1FF-23
- ☐ CFD2RR-48      ☐ CFD2FF-48
- ☐ CFD3RR-72      ☐ CFD3FF-72

### Specifications

Model	Doors/ Shelves	External Dimensions W x D x H	Gross Cu Ft	Shipping Weight	Amps	H/P	CFC-free Refrigerant	Electrical
CFD1RR-23	1 / 3	29.0" x 32.2" x 82.5"	23.0	385	5	1/3	R-134a	115/120V, 60Hz
CFD1FF-23	1 / 3	29.0" x 32.2" x 82.5"	23.0	410	7	1/2	R-404a	115/120V, 60Hz
CFD2RR-48	2 / 6	54.0" x 32.2" x 82.5"	48.0	533	9	1/2	R-134a	115/120V, 60Hz
CFD2FF-48	2 / 6	54.0" x 32.2" x 82.5"	48.0	605	10	3/4	R-404a	115/120V, 60Hz
CFD3RR-72	3 / 9	81.0" x 32.2" x 82.5"	75.0	719	10-1/2	3/4	R-134a	115/120V, 60Hz
CFD3FF-72	3 / 9	81.0" x 32.2" x 82.5"	75.0	759	14	1-1/2	R-404a	115/120V, 60Hz

### Internal Dimensions

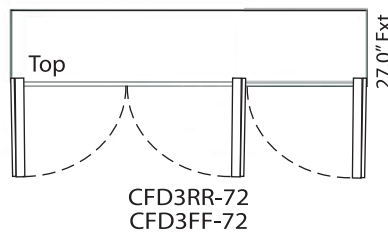
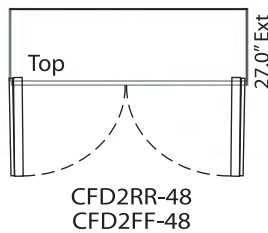
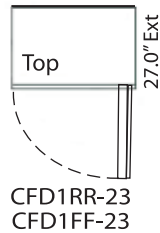
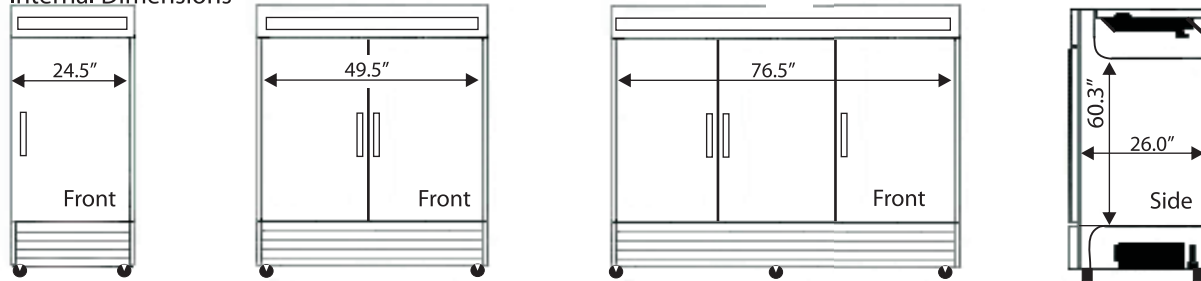

Model	Position	Shelf Dimensions W x D
CFD1RR/1FF	N/A	23.6" x 23.3"
CFD2RR/2FF	R/L	23.6" x 23.3"
CFD3RR/3FF	R/L CTR	23.6" x 23.3" 25.3" x 23.3"

Accommodates all standard sheet pans

Name	Width	Depth	Height
Full	26.0"	18.0"	1.0"
Three Quarters	21.0"	15.0"	1.0"
Half	18.0"	13.0"	
Quarter	9.0"	13.0"	

### Features



Built-in lock & keys



Adjustable shelves & clips

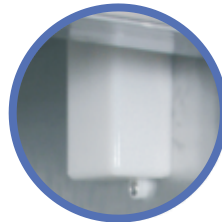

Interior lighting