

# 24" ADA-COMPLIANT REFRIGERATOR

## Perlick Features

- 32" height with leveling legs.
- Designed for maximum capacity while adhering to strict 34-inch counter height ADA-compliant requirements.
- Fully-integrated depth allows flush fit with surrounding cabinetry.
- Zero-clearance hinging allows for abutment with surrounding cabinetry.
- With 3/4-inch wood overlay\* the unit will stand flush with cabinetry.
- Best in Class 700 Btu commercial-grade compressor.
- Front-vented RAPIDcool forced-air refrigeration system.
- Commercial-grade stainless steel interior.
- Industry-exclusive convertible door design allows all doors the ability to be converted to wood overlay\* from stainless steel.
- Low E, UV coated glass provides industry leading insulation and protection.
- Available with solid stainless steel, solid wood overlay\*, glass with stainless trim or glass with wood trim doors, stainless steel or solid wood drawers.
- Industry-exclusive full-extension pull-out shelves makes finding items and restocking easy.
- Full-extension shelves are adjustable.
- Stainless steel ball bearing glides provide smooth movement of shelves.
- Industry-exclusive drawers.
- Refrigerator rated for both food and beverage storage.
- Refrigerator temperature 33° to 39°F.

\* Wood overlay by others.

## MODEL NOS.

- HA24RB-1L
- HA24RB-1R
- HA24RB-2L
- HA24RB-2R
- HA24RB-3L
- HA24RB-3R
- HA24RB-4L
- HA24RB-4R
- HA24RB-5
- HA24RB-6



HA24RB-1L



HA24RB-3L



HA24RB-5



8300 West Good Hope Road • Milwaukee, WI 53223 • Phone 414-353-7060 • Fax 414-353-7069  
Toll Free 800-558-5592 • E-Mail: [Perlick@Perlick.com](mailto:Perlick@Perlick.com) • [www.Perlick.com](http://www.Perlick.com)

Form No. 061610

# Sizes and Specifications 24" ADA-Compliant Refrigerator

Job \_\_\_\_\_  
 Area \_\_\_\_\_  
 Item No. \_\_\_\_\_  
 Model No. \_\_\_\_\_



HA24RB-1L



HA24RB-3L



HA24RB-5

SERIES NOS.		HA24RB Series Refrigerators	
CABINET DIMENSIONS	Length - Inches (mm)	23 7/8" (607)	
	Depth - Inches (mm)	23 15/16" (609)	
	Height - Inches (mm)	32" (812)	
<b>MODEL NOS.</b>	<b>DOOR STYLES</b>		
HA24RB-1L	Solid stainless steel door, hinge left		
HA24RB-1R	Solid stainless steel door, hinge right		
HA24RB-2L	Integrated solid wood overlay* door, hinge left		
HA24RB-2R	Integrated solid wood overlay* door, hinge right		
HA24RB-3L	Stainless steel glass door, hinge left		
HA24RB-3R	Stainless steel glass door, hinge right		
HA24RB-4L	Integrated wood overlay* glass door, hinge left		
HA24RB-4R	Integrated wood overlay* glass door, hinge right		
HA24RB-5	Solid stainless steel drawers		
HA24RB-6	Integrated solid wood overlay* drawers		
INTERIOR VOLUME - CUBIC FOOT (m <sup>3</sup> )		4.3 (12)	
SHELVING		2 Full Extension Shelves	
TEMPERATURE RANGE		33°F to 39°F (.55C to 3.8C)	
RUNNING LOAD - AMPS		2.3	
CONDENSER UNIT H.P.		1/6 HP	
SHIP WT Lbs. (kg)		185 (84)	
INTERIOR	All stainless steel interior.		
EXTERIOR	Black vinyl clad top and sides. Galvanized back. See door finishes under door styles above.		
REFRIGERATION	R-134a capillary tube-type with hermetic compressor. Front access condenser.		
ELECTRICAL	115V, 60Hz., 1 phase, furnished with 3-prong NEMA 5-15 plug, 6 foot long cord.		
PLUMBING	None required. Moisture drains to self evaporating condensate pan.		
OPTIONAL ACCESSORIES	• Door lock • Adjustable leg kit •Caster kit		
WARRANTY	1 year parts & labor; 5 year compressor.		

\* Wood overlay by others.

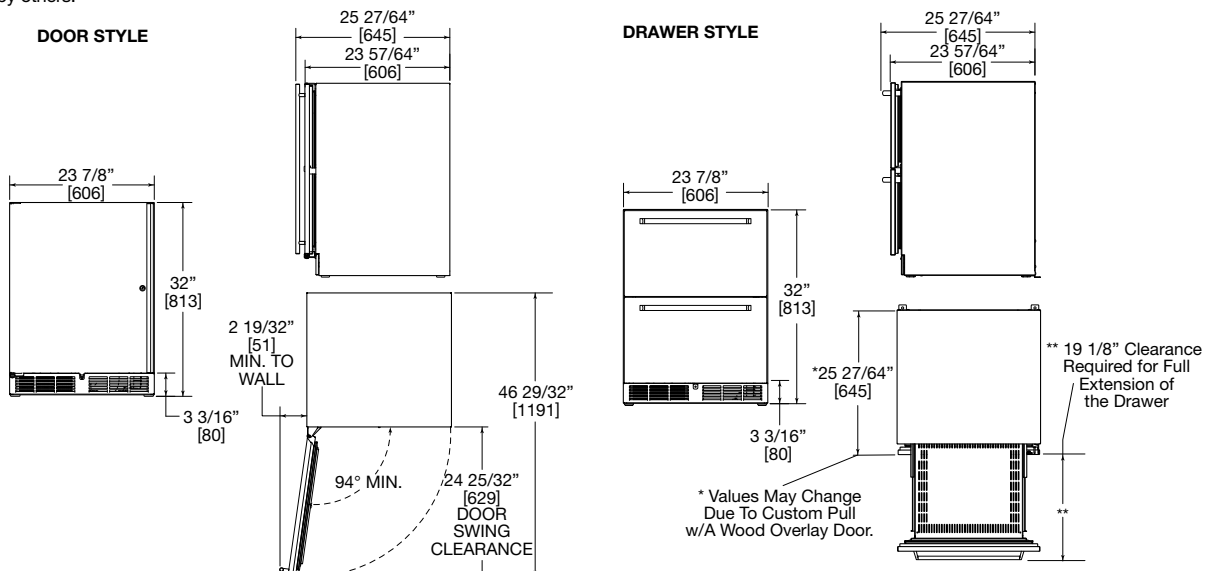

8300 West Good Hope Road • Milwaukee, WI 53223 • Phone 414-353-7060 • Fax 414-353-7069  
 Toll Free 800-558-5592 • E-Mail: Perlick@Perlick.com • www.Perlick.com

Perlick is committed to continuous improvement. Therefore, we reserve the right to change specifications without prior notice. Form No. 061610