

Remote Refrigeration Data

Refer to the below chart to determine the following remote characteristics: Voltage, Amps, BTU's, Refrigerant, and if the following components are included: Condensate Evaporator, Solenoid, Expansion Valve and Temperature Control.

| Model No. | Voltage | Amps | BTU @ 90°F Ambient and Evap. Temp. | Refrig't | Cond. Evap. Yes/No | Solenoid Yes/No | Exp. Valve Yes/No | Temp Control |
|---------------|----------|------|---------------------------------------|----------|-----------------------|--------------------|----------------------|----------------|
| G10000, etc. | 115/60/1 | 4.1 | 1520 @ +20°F Evap | R-134a | Yes | Yes | Yes | Microprocessor |
| G10002P, etc. | 115/60/1 | 4.1 | 1520 @ +20°F Evap | R-134a | Yes | Yes | Yes | Microprocessor |
| G11000, etc. | 115/60/1 | 4.1 | 2410 @ +20°F Evap | R-134a | Yes | Yes | Yes | Microprocessor |
| G11002P, etc. | 115/60/1 | 4.1 | 2400 @ +20°F Evap | R-134a | Yes | Yes | Yes | Microprocessor |
| G12010, etc. | 115/60/1 | 10.6 | 1930 @ -10°F Evap | R-404A | Yes | Yes | Yes | Microprocessor |
| G20000, etc. | 115/60/1 | 5.2 | 2410 @ +20°F Evap | R-134a | Yes | Yes | Yes | Microprocessor |
| G20004P, etc. | 115/60/1 | 5.2 | 2410 @ +20°F Evap | R-134a | Yes | Yes | Yes | Microprocessor |
| G21000, etc. | 115/60/1 | 5.2 | 4160 @ +20°F Evap | R-134a | Yes | Yes | Yes | Microprocessor |
| G21004P, etc. | 115/60/1 | 5.2 | 4160 @ +20°F Evap | R-134a | Yes | Yes | Yes | Microprocessor |
| G22010, etc. | 115/60/1 | 13.2 | 3080 @ -10°F Evap | R-404A | Yes | Yes | Yes | Microprocessor |
| G30000, etc. | 115/60/1 | 5.2 | 3780 @ +20°F Evap | R-134a | Yes | Yes | Yes | Microprocessor |
| G31010, etc. | 115/60/1 | 13.2 | 4710 @ -10°F Evap | R-404A | Yes | Yes | Yes | Microprocessor |
| G31310, etc. | 115/60/1 | 13.2 | 4710 @ -10°F Evap | R-404A | Yes | Yes | Yes | Microprocessor |
| G32000, etc. | 115/60/1 | 5.2 | 5330 @ +20°F Evap | R-134a | Yes | Yes | Yes | Microprocessor |
| R/AHT132W | 115/60/1 | 1.5 | 2400 @ +20°F Evap | R-134a | No | Yes | Yes | Intela-Traul |
| R/AHT132EW | 115/60/1 | 1.5 | 2400 @ +20°F Evap | R-134a | No | Yes | Yes | Intela-Traul |
| R/AHT232W | 115/60/1 | 2.0 | 4360 @ +20°F Evap | R-134a | No | Yes | Yes | Intela-Traul |
| R/AHT332W | 115/60/1 | 2.5 | 4360 @ +20°F Evap | R-134a | No | Yes | Yes | Intela-Traul |
| R/AHT232N | 115/60/1 | 2.0 | 4360 @ +20°F Evap | R-134a | No | Yes | Yes | Intela-Traul |
| R/AHT332N | 115/60/1 | 2.5 | 4360 @ +20°F Evap | R-134a | No | Yes | Yes | Intela-Traul |
| R/AHT126W | 115/60/1 | 1.5 | 2400 @ +20°F Evap | R-134a | No | Yes | Yes | Intela-Traul |
| R/AHT226W | 115/60/1 | 2.0 | 2400 @ +20°F Evap | R-134a | No | Yes | Yes | Intela-Traul |
| R/AHT132D | 115/60/1 | 1.5 | 2400 @ +20°F Evap | R-134a | No | Yes | Yes | Intela-Traul |
| R/AHT232D | 115/60/1 | 2.0 | 4360 @ +20°F Evap | R-134a | No | Yes | Yes | Intela-Traul |
| R/AHT132WP | 115/60/1 | 2.0 | 2400 @ +20°F Evap | R-134a | No | Yes | Yes | Intela-Traul |
| R/AHT232WP | 115/60/1 | 2.5 | 4360 @ +20°F Evap | R-134a | No | Yes | Yes | Intela-Traul |
| R/AHT332WP | 115/60/1 | 3.0 | 4360 @ +20°F Evap | R-134a | No | Yes | Yes | Intela-Traul |
| R/AHT232NP | 115/60/1 | 2.5 | 4360 @ +20°F Evap | R-134a | No | Yes | Yes | Intela-Traul |
| R/AHT332NP | 115/60/1 | 3.0 | 4360 @ +20°F Evap | R-134a | No | Yes | Yes | Intela-Traul |
| R/AHT126WP | 115/60/1 | 2.0 | 2400 @ +20°F Evap | R-134a | No | Yes | Yes | Intela-Traul |
| R/AHT226WP | 115/60/1 | 2.5 | 2400 @ +20°F Evap | R-134a | No | Yes | Yes | Intela-Traul |
| R/ALT132W | 115/60/1 | 7.5 | 2160 @ -20°F Evap | R-404A | No | Yes | Yes | Intela-Traul |
| R/ALT232W | 115/60/1 | 10.0 | 3790 @ -20°F Evap | R-404A | No | Yes | Yes | Intela-Traul |
| R/ALT332W | 115/60/1 | 11.0 | 5220 @ -20°F Evap | R-404A | No | Yes | Yes | Intela-Traul |
| R/ALT232N | 115/60/1 | 10.0 | 3790 @ -20°F Evap | R-404A | No | Yes | Yes | Intela-Traul |
| R/ALT332N | 115/60/1 | 11.0 | 5220 @ -20°F Evap | R-404A | No | Yes | Yes | Intela-Traul |
| R/ALT126W | 115/60/1 | 4.0 | 1980 @ -20°F Evap | R-404A | No | Yes | Yes | Intela-Traul |
| R/ALT226W | 115/60/1 | 7.5 | 3790 @ -20°F Evap | R-404A | No | Yes | Yes | Intela-Traul |
| R/ALT132D | 115/60/1 | 6.0 | 2160 @ -20°F Evap | R-404A | No | Yes | Yes | Intela-Traul |
| R/ALT232D | 115/60/1 | 10.0 | 3790 @ -20°F Evap | R-404A | No | Yes | Yes | Intela-Traul |
| R/ARI132L | 115/60/1 | 2.0 | 2400 @ +20°F Evap | R-134a | No | Yes | Yes | Intela-Traul |
| R/ARI232L | 115/60/1 | 3.0 | 4360 @ +20°F Evap | R-134a | No | Yes | Yes | Intela-Traul |
| R/ARI332L | 115/60/1 | 4.0 | 5330 @ +20°F Evap | R-134a | No | Yes | Yes | Intela-Traul |
| R/ARI132LP | 115/60/1 | 3.0 | 2400 @ +20°F Evap | R-134a | No | Yes | Yes | Intela-Traul |
| R/ARI232LP | 115/60/1 | 4.0 | 4360 @ +20°F Evap | R-134a | No | Yes | Yes | Intela-Traul |
| R/ARI332LP | 115/60/1 | 5.0 | 5330 @ +20°F Evap | R-134a | No | Yes | Yes | Intela-Traul |
| R/ARI132H | 115/60/1 | 2.0 | 2400 @ +20°F Evap | R-134a | No | Yes | Yes | Intela-Traul |
| R/ARI232H | 115/60/1 | 3.0 | 4360 @ +20°F Evap | R-134a | No | Yes | Yes | Intela-Traul |
| R/ARI332H | 115/60/1 | 4.0 | 5330 @ +20°F Evap | R-134a | No | Yes | Yes | Intela-Traul |
| R/AIF132L | 115/60/1 | 7.5 | 2160 @ -20°F Evap | R-404A | No | Yes | Yes | Intela-Traul |
| R/AIF232L | 115/60/1 | 11.0 | 5220 @ -20°F Evap | R-404A | No | Yes | Yes | Intela-Traul |
| R/AIF332L | 208/115 | 12.0 | 7580 @ -20°F Evap | R-404A | No | Yes | Yes | Intela-Traul |



TRAULSEN
 4401 BLUE MOUND RD.
 PHONE 1 (800) 825-8220
 Website: www.traulsen.com

FT. WORTH, TX 76106
 FAX-MKTG. 1 (817) 624-4302

Remote Refrigeration Data

| Model No. | Voltage | Amps | BTU @ 90°F Ambient and Evap. Temp. | Cond. Evap. | | Solenoid Yes/No | Exp. Valve Yes/No | Temp Control |
|--------------|---------------|------|--|------------------|--------|--------------------|----------------------|--------------|
| | | | | Refrig't | Yes/No | | | |
| R/ACV132W | 115/60/1 | 7.5 | 2160 @ -10°F Evap | R-404A | No | Yes | Yes | No |
| R/ACV232W | 115/60/1 | 10.0 | 1870 @ -10°F Evap | R-404A | No | Yes | Yes | No |
| R/ADT132EW | 115/60/1 | 6.5 | F-1850 @ -20°F Evap R-1130 @ +20°F Evap | R-404A R-134a | No | Yes | Yes | Intela-Traul |
| R/ADT132W | 115/60/1 | 6.5 | F-1850 @ -20°F Evap R-1130 @ +20°F Evap | R-404A R-134a | No | Yes | Yes | Intela-Traul |
| R/ADT232W | 115/60/1 | 8.0 | F-2170 @ -20°F Evap R-1730 @ -20°F Evap | R-404A R-134a | No | Yes | Yes | Intela-Traul |
| R/ADT332W | 115/60/1 | 9.0 | F-2160 @ -20°F Evap R-4360 @ +20°F Evap | R-404A R-134a | No | Yes | Yes | Intela-Traul |
| R/ADT232N | 115/60/1 | 8.0 | F-2170 @ -20°F Evap R-1730 @ +20°F Evap | R-404A R-134a | No | Yes | Yes | Intela-Traul |
| R/ADT332N | 115/60/1 | 9.0 | F-2160 @ -20°F Evap R-4360 @ +20°F Evap | R-404A R-134a | No | Yes | Yes | Intela-Traul |
| R/ADT132D | 115/60/1 | 6.5 | F-1850 @ -20°F Evap R-1130 @ +20°F Evap | R-404A R-134a | No | Yes | Yes | Intela-Traul |
| R/ADT232D | 115/60/1 | 6.5 | F-1850 @ -20°F Evap R-1130 @ +20°F Evap | R-404A R-134a | No | Yes | Yes | Intela-Traul |
| RDH232W | 208/115-1-60 | 10.0 | 2400 @ +20°F Evap | R-134a | No | Yes | Yes | Intela-Traul |
| RDH232WP | 208/115-1-60 | 10.0 | 2400 @ +20°F Evap | R-134a | No | Yes | Yes | Intela-Traul |
| RRI264L | 115/60/1 | 4.0 | 2 X 4360 @ +20°F Evap | R-134a | No | Yes | Yes | Intela-Traul |
| RRI364L | 115/60/1 | 8.0 | 2 X 5330 @ +20°F Evap | R-134a | No | Yes | Yes | Intela-Traul |
| RRI264LP | 115/60/1 | 4.0 | 2 X 4360 @ +20°F Evap | R-134a | No | Yes | Yes | Intela-Traul |
| RRI364LP | 115/60/1 | 8.0 | 2 X 5330 @ +20°F Evap | R-134a | No | Yes | Yes | Intela-Traul |
| RIF264L | 208/115/60/1* | 12.0 | 10,440 @ -20°F Evap | R-404A | No | Yes | Yes | Intela-Traul |
| RIF364L | 208/115/60/1* | 14.0 | 15,160 @ -20°F Evap | R-404A | No | Yes | Yes | Intela-Traul |
| RHT232NSL | 115/60/1 | 6.5 | 5330 @ +20°F Evap | R-134a | No | Yes | Yes | Intela-Traul |
| RHT232NHG | 115/60/1 | 2.0 | 4360 @ +20°F Evap | R-134a | No | Yes | Yes | Intela-Traul |
| TE036HT | 115/60/1 | 3.2 | 2440 @ +20°F Evap | R-404A | Yes | Yes | Yes | Intela-Traul |
| TE048HT | 115/60/1 | 3.3 | 2440 @ +20°F Evap | R-404A | Yes | Yes | Yes | Intela-Traul |
| TE060HT | 115/60/1 | 3.5 | 2440 @ +20°F Evap | R-404A | Yes | Yes | Yes | Intela-Traul |
| TE065HT | 115/60/1 | 3.5 | 2440 @ +20°F Evap | R-404A | Yes | Yes | Yes | Intela-Traul |
| TE072HT | 115/60/1 | 3.6 | 2440 @ +20°F Evap | R-404A | Yes | Yes | Yes | Intela-Traul |
| TE084HT | 115/60/1 | 3.7 | 2440 @ +20°F Evap | R-404A | Yes | Yes | Yes | Intela-Traul |
| TE096HT | 115/60/1 | 3.9 | 4090 @ +20°F Evap | R-404A | Yes | Yes | Yes | Intela-Traul |
| TE110HT | 115/60/1 | 4.0 | 4090 @ +20°F Evap | R-404A | Yes | Yes | Yes | Intela-Traul |
| TU044HT | 115/60/1 | 3.3 | 2440 @ +20°F Evap | R-404A | Yes | Yes | Yes | Intela-Traul |
| TU072HT | 115/60/1 | 3.7 | 2440 @ +20°F Evap | R-404A | Yes | Yes | Yes | Intela-Traul |
| TU100HT | 115/60/1 | 3.9 | 2440 @ +20°F Evap | R-404A | Yes | Yes | Yes | Intela-Traul |
| VPS48/54S | 115/60/1 | 6.0 | 1870 @ +10°F Evap | R-404A | No | Yes | Yes | ETC |
| VPS66/72/90S | 115/60/1 | 6.5 | 3160 @ +10°F Evap | R-404A | No | Yes | Yes | ETC |

NOTES:

- 1) Remote INTELA-TRAUL® equipped units do not require use of a temperature control.
- 2) Cord and plug are not supplied with remote units.
- 3) Listed BTU rating shown is the required BTU's delivered to the unit at the evaporator coil.
- 4) Compressor HP not supplied by Traulsen. Compressor size should be determined by a qualified refrigeration technician based on the delivered BTU rating at the unit and actual jobsite requirements.
- 5) To determine approximate remote model weights, please deduct 40 lbs. from the respective self-contained models net or gross weight.
- 6) Standard Traulsen five year compressor warranty does not apply to remote units.
- 7) Condensate Removal: except where a BMCE is listed above, all remote models require provisions to be made to allow for condensate removal. As supplied standard, these models include only a drain tube exiting the evaporator compartment on top of the cabinet from which condensate will drip. Optional condensate removal provisions include a drain line extended down the cabinet back (n/a for pass-thru or roll-thru models) or optional Top-Mounted Electric Condensate Evaporator. Note: provision of the first option will add approximately 7/8" to the overall cabinet depth, while the latter will add approximately 1.5 amps to the cabinets full load amp rating. Cabinets built with optional TMCE's or BMCE's include arrangements to allow for these to be plugged directly into the unit.
- 8) Traulsen does not recommend the use of casters with remote models (legs supplied standard on G-Series remote units).
- 9) Refrigeration connections provided are 1/4" O.D. for the liquid line and either 1/2" or 3/4" O.D. for the suction line, no other connections are required.
- 10) The solenoid valve provided is wired at the factory directly to the control, and so no electrical connections are required between the unit and remote compressor.

Continued product development may necessitate specification changes without notice.

Part No. TR35837 (revised 1/10)

TRAULSEN
4401 BLUE MOUND RD.
PHONE 1 (800) 825-8220
Website: www.traulsen.com

FT. WORTH, TX 76106
FAX-MKTG. 1 (817) 624-4302



| | | |
|------------------|----------|-------------------|
| Project | Quantity | Item # |
| Model Specified: | | CSI Section 11400 |

"D-Width" Reach-In Freezer Models/ Self-Contained



Model RLT132DUT-FHS
(shown with optional casters)



Stainless Exterior
& Interior



Stainless Exterior,
Anodized Alumi-
num Interior

One & Two Section Models, 26" Deep

| | |
|----------------------------------|---------------|
| 1-Section Full Length Door Model | RLT132DUT-FHS |
| 2-Section Full Length Door Model | RLT232DUT-FHS |
| 1-Section Half Length Door Model | RLT132DUT-HHS |
| 2-Section Half Length Door Model | RLT232DUT-HHS |

| | |
|----------------------------------|---------------|
| 1-Section Full Length Door Model | ALT132DUT-FHS |
| 2-Section Full Length Door Model | ALT232DUT-FHS |
| 1-Section Half Length Door Model | ALT132DUT-HHS |
| 2-Section Half Length Door Model | ALT232DUT-HHS |

The R & A Series represent Traulsen's Top-of-the-Line product offering. The "D-Width" reach-in freezer models are all designed to offer maximum interior storage capacity within a narrow 24" or 48" footprint. Each is supplied standard with such high quality features as balanced refrigeration systems, microprocessor controls, communications ability and stainless steel exteriors. Additionally, they offer the widest range of optional accessories to choose from, and can be specified for use with many different applications, including: Foodservice, Correctional, Institutional, Export, etc.

Standard Product Features

- R-Series: Stainless Steel Exterior & Interior
- A-Series: Stainless Steel Exterior/Anodized Aluminum Interior
- INTELA-TRAUL® Microprocessor Control System
- Balanced, Self-Contained Refrigeration System Using R-404A
- Scroll Blower Type Evaporator Fan (two section models only)
- Biased Return Air Duct (two section models only)
- Full or Half Length Stainless Steel Doors With Locks
- Self-Closing Doors With Stay Open Feature At 120 Degrees
- Guaranteed For Life Cam-Lift Hinges
- Guaranteed For Life Horizontal Work Flow Door Handle
- Standard Door Hinging: 132D = Right, 232D = Left/Right (other hinging not available for two-section models)
- Automatically Activated Incandescent Lights
- Stainless Steel Breaker Caps
- Three Adjustable Wire Shelves Per Section, Supported On Shelf Pins (installed at the factory)
- Automatic Non-Electric Condensate Evaporator (two section models only)
- Magnetic Snap-In Door Gaskets
- Gasket Protecting Metal Door Liner
- Controllable Anti-Condensate Door Perimeter Heaters
- Thermostatic Expansion Valve Metering Device
- Stainless Steel One-Piece Louver Assembly
- 9' Cord & Plug Attached
- Set of Four (4) 6" High Adjustable Stainless Steel Legs
- One Year Parts And Labor Warranty
- Two Year Control Warranty (parts and labor)
- Five Year Compressor Warranty

Options & Accessories

- Stainless Steel Finished Back With Rear Louvers
- No. 1 Type Tray Slides To Accommodate either (1) 18" x 26" or (2) 14" x 18" Pans
- No. 2 Type Tray Slides To Accommodate (1) 18" x 26" Pans
- Additional Wire Shelves or Optional Stainless Steel Shelves
- Optional 220/50/1 or 208/115/60/1 Voltages
- Kool Klad Exterior Laminate Decor
- Set of Four (4) 4-5/8" or 6" High Casters In Lieu of Legs
- Other Support Options: 4-1/2" High Base or 6" High Kickplate
- Remote Applications (see form TR35837 for more details)
- Water Cooled Self-Contained Condenser Suitable for Connection To Glycol
- Two Year Service/Labor Warranty Available



Listed by Underwriters Laboratories Inc.,
to U.S. and Canadian safety standards and
Listed by NSF International.

Approval: _____



TRAULSEN
4401 BLUE MOUND RD.
PHONE 1 (800) 825-8220
Website: www.traulsen.com

FT. WORTH, TX 76106
FAX-MKTG. 1 (817) 624-4302

| | | |
|------------------|----------|-------------------|
| Project | Quantity | Item # |
| Model Specified: | | CSI Section 11400 |

Specifications

Construction, Hardware and Insulation

Cabinet exterior front, one piece sides, louver assembly and doors are constructed of 20 gauge stainless steel with #4 finish. Cabinet interior and door liners are constructed of stainless steel (anodized aluminum in the A-Series). The exterior cabinet top, back and bottom are constructed of heavy gauge aluminized steel. A set of four (4) adjustable 6" high stainless steel legs are included.

Doors are equipped with a gasket protecting metal door pan, removable plug cylinder locks and guaranteed for life cam-lift, gravity action, self-closing metal, glide hinges with stay open feature at 120 degrees. Hinges include a concealed switch to automatically activate the interior incandescent lighting. Guaranteed for life, work flow door handles are mounted horizontally over recess in door which limits protrusion from door face into aiseways. Doors have seamless, polished metal corners.

Easily removable for cleaning, vinyl magnetic door gasket assures tight door seal. Anti condensate heaters are located behind each door opening.

Both the cabinet and door(s) are insulated with an average of 2" thick high density, non-CFC, foamed in place polyurethane.

| DIMENSIONAL DATA | R/ALT132DUT | R/ALT232DUT |
|---------------------------------|-----------------------------|-----------------------------|
| Net capacity cu. ft. | 17.7 (501 cu l) | 42.0 (1190 cu l) |
| Length - overall in. | 24 (61.0 cm) | 48 (121.9 cm) |
| Depth - overall in. | 35 (88.8 cm) | 35 (88.8 cm) |
| Depth - less handle in. | 33 $\frac{3}{4}$ (84.4 cm) | 33 $\frac{3}{4}$ (84.4 cm) |
| Depth - over body in. | 32 (81.3 cm) | 32 (81.3 cm) |
| Depth - door open 90° in. | 54 $\frac{3}{4}$ (139.1 cm) | 54 $\frac{3}{4}$ (139.1 cm) |
| Clear door width in. | 18 $\frac{5}{8}$ (47.3 cm) | 19 $\frac{7}{16}$ (49.7 cm) |
| Clear half-door height in. | 27 $\frac{1}{2}$ (69.9 cm) | 27 $\frac{1}{2}$ (69.9 cm) |
| Clear full-door height in. | 57 $\frac{7}{8}$ (146.3 cm) | 57 $\frac{7}{8}$ (146.3 cm) |
| Height - overall on 6" legs | 83 $\frac{3}{4}$ (211.5 cm) | 83 $\frac{3}{4}$ (211.5 cm) |
| RLT Net Wt. lbs. | 360 (163 kg) | 619 (280 kg) |
| ALT Net Wt. lbs. | 320 (145 kg) | 560 (254 kg) |
| No. Standard Shelves | 3 | 6 |
| Shelf area sq. ft. ¹ | 14.2 (1.3 sq m) | 31.6 (2.9 sq m) |
| ELECTRICAL DATA | | |
| Voltage | 115/60/1 | 115/60/1 |
| Feed wires with Ground | 3 | 3 |
| Full load amperes | 11.5 | 14.9 |
| REFRIGERATION DATA | | |
| Refrigerant | R-404A | R-404A |
| BTU/HR H.P. ² | 1890 (1/2 HP) | 3070 (3/4 HP) |

NOTES

NOTE: Figures in parentheses reflect metric equivalents.

- Area of standard shelf compliment only, does not include storage area of additional shelves or available on cabinet bottom.
- Based on a 90 degree F ambient and -20 degree F evaporator.
- For approximate remote weights deduct 40 lbs. from respective net or gross weight. For other information on remote models, please refer to form TR35837.

REQUIRED CLEARANCES

In order to assure optimum performance, the condensing unit **MUST** have an adequate supply of air for cooling purposes. Therefore, the operating location must either have a minimum of 12" clearance overhead of the condensing unit or allow for unrestricted air flow at the back of the unit. Clearance of at least 12" above is required in order to perform certain maintenance tasks.



One Section Models Equipped With One NEMA 5-15P Plug

NOTE: Full load amps and plug style may vary depending on electrical options chosen and condensing unit employed.



Two Section Models Equipped With One NEMA 5-20P Plug

NOTE: When ordering please specify: Voltage, Hinging, Door Size, Options and any additional warranties.

Continued product development may necessitate specification changes without notice. Part No. TR35765 (revised 1/10)

Refrigeration System

A top mounted, self-contained, balanced refrigeration system using R-404A refrigerant is conveniently located behind the one piece louver assembly. It features an easy to clean front facing condenser, thermostatic expansion valve, air-cooled hermetic compressor and a plenum effect blower coil. Two section models include a large, high humidity evaporator coil located outside the food zone and a top mounted non-electric condensate evaporator. One section models include an interior mounted ceiling coil and bottom mounted electric condensate evaporator. A 9' cord and plug is provided. Standard operating temperature is 0 to -5°F.

Controller

The easy to use water resistant INTELA-TRAUL® microprocessor control system is supplied standard. Unit is NAFEM Data Protocol communication (NDP) ready. Optional hardware required to be NDP compliant. Third party software required for network connection. It includes a 3-Digit LED Display, Fahrenheit or Celsius Temperature Scale Display Capability, Defrost Lockouts, and an RS485 data port. In addition it includes audio/visual alarms for: Hi/Lo Cabinet Temperature, Door Open, Clean Condenser, Evaporator Coil and Discharge Line Sensor Failures, and Power Supply Interruption.

Interior

Standard interior arrangements include three (3) wire shelves per section, mounted on shelf pins. Shelves are full-width, and do not have any large gaps between them requiring the use of "bridge" or "junior shelves." Recommended load limit per shelf should not exceed 225 lbs. Optional tray slides may be purchased in combination with, or in lieu of these. Both standard and optional interior arrangements are completely installed at the factory.

Warranties

Both a one year parts and labor warranty and a five year compressor warranty (self-contained models only) are provided standard. An optional 2nd year extended parts and labor warranty is also available. In addition the INTELA-TRAUL® control is warranted by a two year parts and labor warranty.

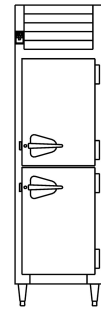

Elevation - R/ALT132DUT

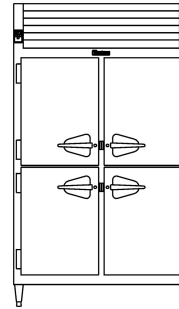

Elevation - R/ALT232DUT

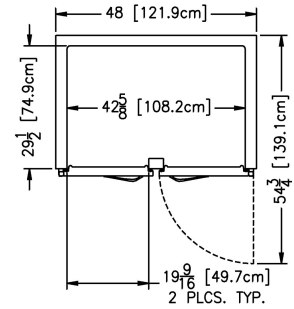

Plan - R/ALT232DUT

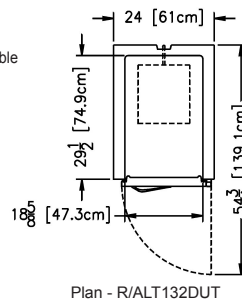

Plan - R/ALT132DUT

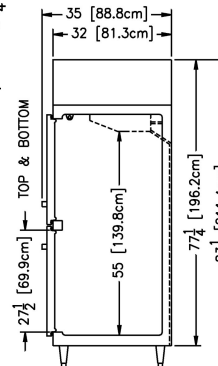

Section - R/ALT132DUT

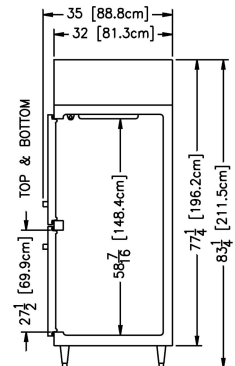

Section - R/ALT232DUT

TRAULSEN
4401 BLUE MOUND RD.
PHONE 1 (800) 825-8220
Website: www.traulsen.com

FT. WORTH, TX 76106
FAX-MKTG. 1 (817) 624-4302

