

ScaleBlocker™ WATER FILTER SYSTEM

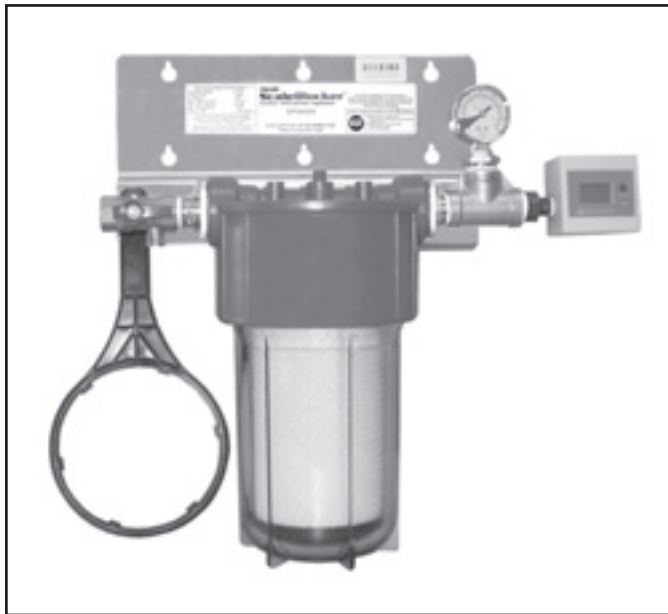

- SPS600V
- SPS620V

STANDARD FEATURES

- Single cartridge design.
- Patented technology reduces limescale with-out chemicals or additives.
- Reduces the need for deliming.
- Mounting bracket with clear filter housing and red cap.
- Shut off valve and pressure gauge.
- Incoming water parameter:
 - pH 6-9
 - Alkalinity ppm 80 - 100
 - Chlorine ppm 0 - 4
 - Hardness ppm 0 - 300
- 3/4 NPTF inlet and outlet.
- Shut off valve with cold water 1/4" compression connection for unfiltered connection.
- Water pressure gauge.
- Water flow meter with reminder setting.

System tested and certified by NSF International



- ANS/NSF Standard 53-Health Claims
 - Cysts Reduction: Cryptosporidium, Giardia, Entamoeba
 - Turbidity Reduction
- ANS/NSF Standard 42-Aesthetic Claims
 - Chlorine Reduction, Class I
 - Taste and Odor Reduction

SPECIFICATIONS:

Water filter system, Vulcan-Hart Model No. SPS___V. Single cartridge design. Patented technology reduces limescale with-out chemicals or additives. Reduces the need for deliming. Mounting bracket with clear filter housing and red cap. Shutoff valve and gauge. Incoming water parameters are pH 6 - 9, Alkalinity ppm 80 - 100, Chlorine ppm 0 - 4, Hardness ppm 0 - 300. 3/4 NPTF inlet and outlet.

Exterior dimensions:

SPS600V: 14"w x 10"d x 18 1/2"h.

SPS620V: 14"w x 10"d x 28"h.

NSF tested and certified.



ScaleBlocker™ WATER FILTER SYSTEM

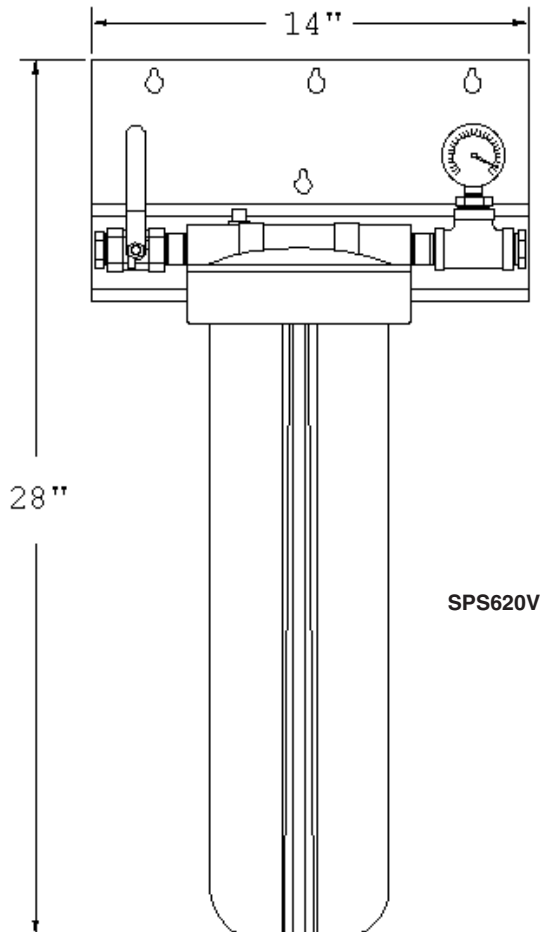
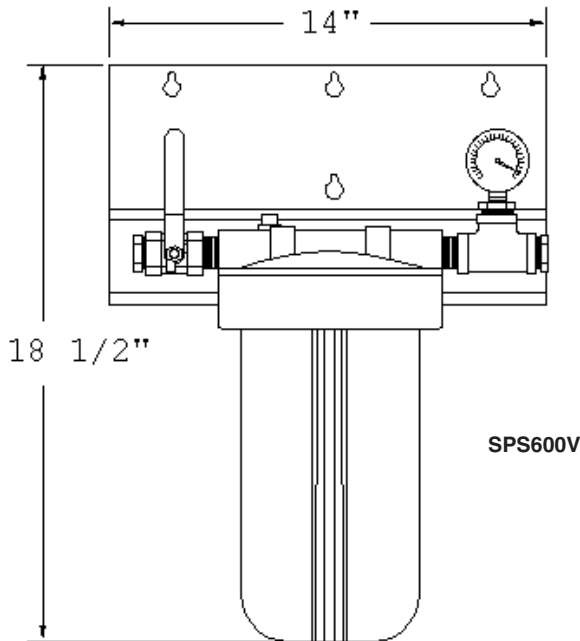

NOTES:

1. Dimensions which locate the below connections have a tolerance of + or - 3" (+ or - 77mm).

SPS600V

Service Flow	0-2 GPM
Service Life	7,500 Gal
Inlet / Outlet	3/4" NPT F
Inlet Min / Max Pressure	40-125 PSIG
Min / Max Temperature	45-100F (7-37C)
Weight, Operating	21 Lbs. (9.5 kg)

SPS620V

Service Flow	0-4 GPM
Service Life	12,000 Gal
Inlet / Outlet	3/4" NPT F
Inlet Min / Max Pressure	40-125 PSIG
Min / Max Temperature	45-100F (7-37C)
Weight, Operating	32 Lbs. (15.5 kg)

2. Installation of backflow preventers, vacuum breakers, other code requirements and local code compliance is the responsibility of the owner and installer.
3. Filter clearance needed for access:
Front 13"
Bottom 4"
4. Plastic drains are not recommended due to inherent limited temperatures of the plastic. Boiler purge temperatures may exceed 180°F. The installer may be required to provide means to reduce boiler purge water temperatures to be that of condensate temperature of 140°F or below.
5. This appliance is manufactured for commercial installation only and not intended for home use.

WATER QUALITY STATEMENT:

Water from ScaleBlocker™ System should only be connected to the boiler / generator feed and not the condenser connection of the steamer. Systems are not to be used where water is microbiologically unsafe or with water of unknown quality without adequate disinfections before and after use. Connecting to a municipal water supply complies with this requirement.

NOTE: In line with its policy to continually improve its products, Vulcan-Hart Company reserves the right to change materials and specifications without notice.