



"Your Solutions Partner"

# Specifications

F.O.B. Sedalia, Missouri 65301



**G-5-DLSS**

### OPTIONS:

- 14 gauge tops
- Thermostat, Robertshaw - **T-TH**
- Special height legs - **T-SP-HT-LEGS**
- Serving Shelves - **T956-x, T956-460-x, T956-461-x**
- Adapter plates - **T31, T32, T33**
- Telescope covers - **546, 548**
- 3-bar tray slides - **T3BTS-FX/HD-x**
- Solid tray slide - **TSOLID-FX/HD-x**
- Veneer panels - **T-x-P**
- Powder coat paint colors

### AGENCY LISTINGS:



**DUKE MANUFACTURING CO.**  
2305 N. Broadway  
St. Louis, MO 63102

800.735.3853 Toll Free  
314.231.1130 In Missouri  
314.231.5074 Fax  
www.dukemfg.com

Approval Stamp(s):

### PROJECT INFORMATION:

PROJECT: \_\_\_\_\_  
ITEM: \_\_\_\_\_  
QUANTITY: \_\_\_\_\_

### MODEL:

## Thurmaduke Steamtables Hot Food Units - Gas - Deluxe

- G-2-DLPG/G-2-DLSS** 2 top openings
- G-3-DLPG/G-3-DLSS** 3 top openings
- G-4-DLPG/G-4-DLSS** 4 top openings
- G-5-DLPG/G-5-DLSS** 5 top openings
- G-6-DLPG/G-6-DLSS** 6 top openings

### TOP:

- One piece, 16 gauge, 300 Series stainless steel
- Top openings die-stamped, 12" x 20"
- Integral carving/work surface

### HEAT COMPARTMENTS - dry well only:

- Individual burners
- Individual adjustable gas valves
- Individual galvanized steel radiation plates
- Safety pilots
- Gas pressure regulator for unit
- 3500 BTU/hour per burner
- **676** spillage pans - (1) per compartment

### BODY AND INTERIOR SHELF:

- 300 Series stainless steel or paint grip steel
- End panels die-stamped
- 6" polished stainless steel legs

### INTEGRAL DISHSHELF:

- Heavy gauge, one piece stainless steel - 8-1/2" wide
- Housing for control knobs, thermostats and master switch

### SHORT FORM SPECIFICATIONS:

#### Duke Thurmaduke Steamtables - Hot Food - Gas - Deluxe.

Top shall be constructed of one piece, 16 gauge, 300 Series stainless steel, extended on operator's side to provide integral carving or work surface. Each top opening to be die-stamped with raised beaded edges, measuring 12" x 20", fitted with stainless steel removable spillage pan (#676), as standard. Body to be constructed of 20 gauge, 300 Series stainless steel or paint grip steel with powder coat paint, as specified. Body parts made into panels by forming edges into angles and channels which are welded together to provide structural strength. End panels die-stamped with square corners, side opposite operator fully enclosed. Bottom shelf of heavy gauge steel, same as body panels, with edges flanged down at back and ends. Bottom shelf has clearance of 15-1/2". Integral dish shelf shall be made of heavy gauge, one piece stainless steel, 8-1/2" wide with rail on operator's side. Canted, easy-to-reach control knobs and housing for valves, manifold, etc. 6-1/2" clearance between bottom edge of work surface and dish shelf. Each heat compartment liner shall be die-formed, 8" deep, fabricated of heavy gauge stainless steel and insulated on all four sides with 1" fiberglass. Each compartment shall have individual burners, rated at 3500 BTU/hour, for use with natural or propane. Safety pilots standard. Burners to be controlled by adjustable gas valve, with adjustable pilot light. Galvanized steel radiation plate shall be furnished in each heat compartment, with gas pressure regulator provided with each unit to eliminate varying flame height. 6" polished stainless steel legs, adjustable to 7-1/4", to be furnished. **CASTERS NOT AVAILABLE ON GAS UNITS.**



**THURMADUKE STEAMTABLES  
HOT FOOD UNITS - GAS - DELUXE**

- G-2-DLPG/G-2-DLSS** 2 top openings
- G-3-DLPG/G-3-DLSS** 3 top openings
- G-4-DLPG/G-4-DLSS** 4 top openings
- G-5-DLPG/G-5-DLSS** 5 top openings
- G-6-DLPG/G-6-DLSS** 6 top openings

A.I.A. File No. 35-C-13

Catalog No. TST-DGASHOT

THURMADUKE STEAMTABLES - HOT FOOD - GAS - DELUXE

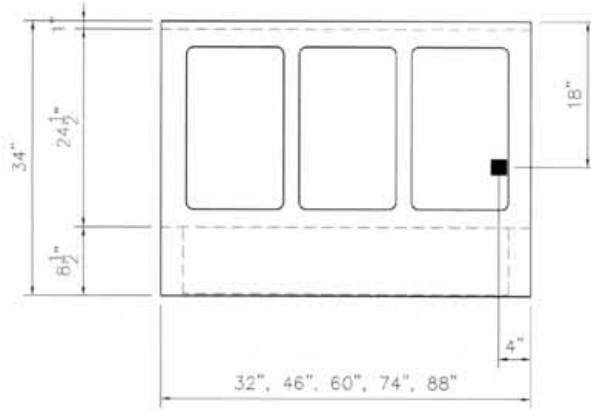

TOP VIEW

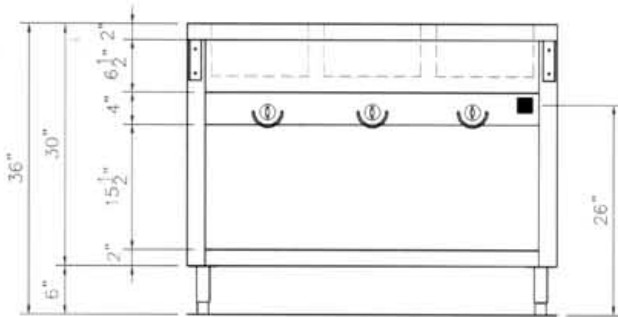

FRONT VIEW

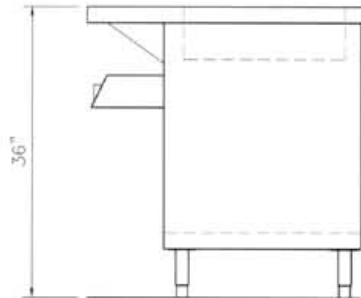

RIGHT SIDE VIEW

POWER SUPPLY		
Model	# Burners	Total BTU
G-2-DLPG/SS	2	7,000
G-3-DLPG/SS	3	10,500
G-4-DLPG/SS	4	14,000
G-5-DLPG/SS	5	17,500
G-6-DLPG/SS	6	21,000

■ - GAS CONNECTION - 1/2" I.P.S.

**G-3-DLSS**

**DIMENSIONS:**

Freight Class: 100

Model		Length		Width		Height		Top Openings	Cube ft. crated	Weight	
Enameled	Stainless	in.	cm	in.	cm	in.	cm			lbs.	kg
G-2-DLPG	G-2-DLSS	32	81.3	34	86.4	36	91.4	2	27.0	255	115.9
G-3-DLPG	G-3-DLSS	46	116.8	34	86.4	36	91.4	3	38.1	335	152.3
G-4-DLPG	G-4-DLSS	60	152.4	34	86.4	36	91.4	4	49.2	410	186.4
G-5-DLPG	G-5-DLSS	74	188.0	34	86.4	36	91.4	5	60.2	495	225.0
G-6-DLPG	G-6-DLSS	88	223.5	34	86.4	36	91.4	6	71.3	595	270.5



**DUKE MANUFACTURING CO.**  
2305 N. Broadway  
St. Louis, MO 63102

800.735.3853 Toll Free  
314.231.1130 In Missouri  
314.231.5074 Fax  
www.dukemfg.com

"Your Solutions Partner"

08/03

Specifications subject to change

Printed in U.S.A.  
©2003, Duke Manufacturing Co.