

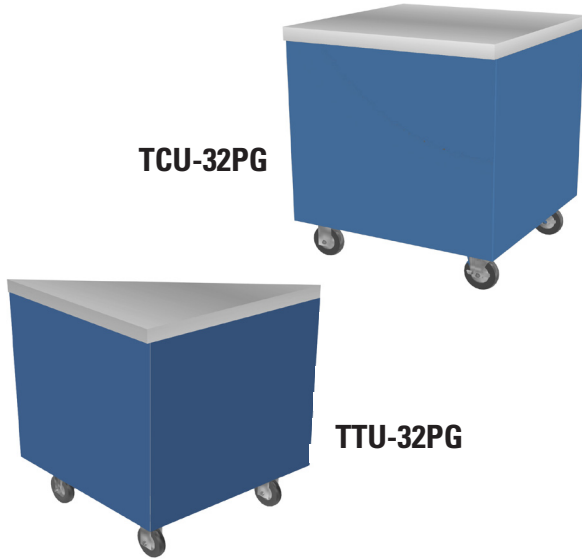

Your Solutions Partner

# Specifications

F.O.B Sedalia, Missouri 65301



TCU-32PG

TTU-32PG

### OPTIONS:

- Internal Locking device
- 14 gauge tops
- Special corner angles
- Workshelves
- Trayslides
- Veneered plastic laminate panels on body
- Powder coat paint colors
- Kickplates s/s or p/g
- 6" adjustable stainless steel legs

### AGENCY LISTING:



**DUKE MANUFACTURING CO.**  
2305 N. Broadway  
St. Louis, MO 63102

800.735.3853 Toll Free  
314.231.1130 In Missouri  
314.231.5074 Fax  
www.dukemfg.com

### Approval Stamp(s):

### PRODUCT INFORMATION:

PROJECT: \_\_\_\_\_  
ITEM: \_\_\_\_\_  
QUANTITY: \_\_\_\_\_

### MODEL:

#### Thurmaduke Serving Systems - Corner & Triangle Units

- TCU-32** Square corner unit
- TTU-90°** Triangular corner unit
- TTU-45°** Triangular corner unit

### TOP:

- 16 gauge, 300 Series stainless steel
- Sound-deadening

### BODY:

- Choice of (12) powder coat paint colors (must choose one):
  - #217105 - Designer White
  - #217150 - Orange Red
  - #217107 - Hollyberry Red
  - #217127 - Fence Green
  - #217102 - Duke Silver
  - #217101 - Semi-Gloss Black
  - #217103 - Natural Almond
  - #217154 - Racing Red
  - #217120 - Sky Blue
  - #217152 - Stone Gray
  - #217113 - Brown Kickplate
  - #217125 - Textured Black
- Stainless steel body
- Fully enclosed - no shelves
- NSF approved 5" diameter polyurethane casters
- 45° triangle unit permanently attached to adjacent unit

### SHORT FORM SPECIFICATIONS:

**Thurmaduke Serving Systems - CORNER & TRIANGLES UNITS.** Top shall be 16ga, 300 series Stainless Steel flanged down edges, flush at ends, 20ga s/s enclosed body, 5" dia. NSF approved swivel casters, 2 w/ locks, counter top made to order for inside or outside corner applications.



**THURMADUKE SERVING SYSTEMS  
CORNER & TRIANGLE UNITS**

- TCU-32** Square corner unit
- TTU-90°** Triangular corner unit
- TTU-45°** Triangular corner unit

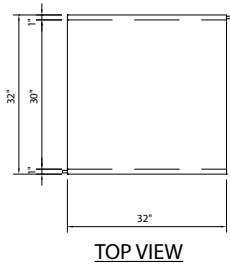

**TCU-32**

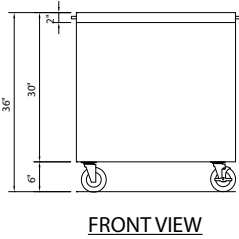

FRONT VIEW

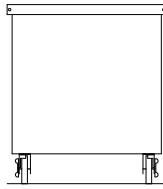

RIGHT SIDE VIEW

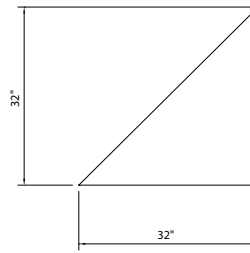

**TTU-90**

TOP VIEW

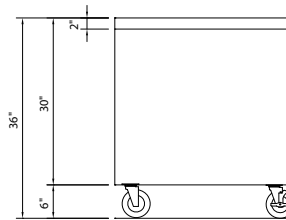

FRONT VIEW

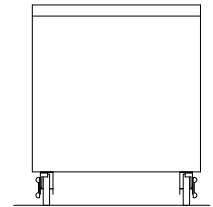

RIGHT SIDE VIEW

**DIMENSIONS:**

Freight Class: 150

Model	Length		Width		Height		Cube ft. crated	Weight	
	in.	cm	in.	cm	in.	cm		lbs.	kg
<b>TCU-32</b>	32	81.3	32	81.3	36	91.4	33.9	175	79.6
<b>TTU-90°</b>	32	81.3	32	81.3	36	91.4	33.9	175	79.6
<b>TTU-45°</b>	32	81.3	32	81.3	36	91.4	33.9	150	68.2

**INSTALLATION DATA:**

Overhang on top depends on line-up. Contact Factory for more information.



**DUKE MANUFACTURING CO.**

2305 N. Broadway  
St. Louis, MO 63102

800.735.3853 Toll Free  
800.231.1130 In Missouri  
314.231.5074 Fax  
[www.dukemfg.com](http://www.dukemfg.com)

Specification subject to change