

Foodservice Equipment • Material Handling, Healthcare & Cleanroom Equipment • Retail Display

Short Form Specifications

Eagle Piggyback Wall Mounted Shelving System, 3-tier bracket kit model_____. (One, Two, Three Shelves) patented Quad-Truss®, open wire design chrome finished wire shelf with chrome plated wall brackets. Brackets can be secured directly to wall studs with no wall backing required.

Eagle Piggyback Wall Mounted Shelving System, 5-tier bracket kit model_____. (Three, Four, Five Shelves) patented Quad-Truss®, open wire design chrome finished wire shelves with chrome plated wall brackets. Brackets can be secured directly to wall studs with no wall backing required.

Item #: _____
 Model #: _____
 Project #: _____
 SIS #: _____

Optional Accessories	Model #	Qty.

New Piggyback - Wall Mounted Shelf Kits



PATENT PENDING!

ALLOWS FOR FREEDOM TO POSITION THE SHELF ANYWHERE ON THE BRACKETS WITHOUT THE USE OF FASTENERS.

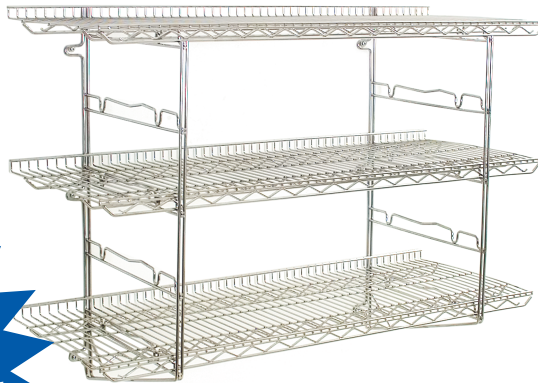

5-tier bracket kit provided with 3 shelves - S3-5B-SSW1848C

- Brackets can be mounted to studs – no wall backing required.
- Three or five tier kits available.
- Freedom to move the shelves left or right.
- Wire design allows for air circulation.
- Chrome finish.
- Available in 18" (457mm) width.
- Shelf lengths range from 24" to 60" (610 to 1524mm).
- No tools required to attach shelf to wall brackets.

Spec sheets available for viewing, printing or downloading from our online literature library at www.eaglegrp.com

For custom configuration or fabrication needs, contact our **SpecFAB Division**.
 Phone: (302) 653-3000. FAX: (302) 653-3091.
 E-mail: specfab@eaglegrp.com

Piggyback Wall Mounted Shelf Kits

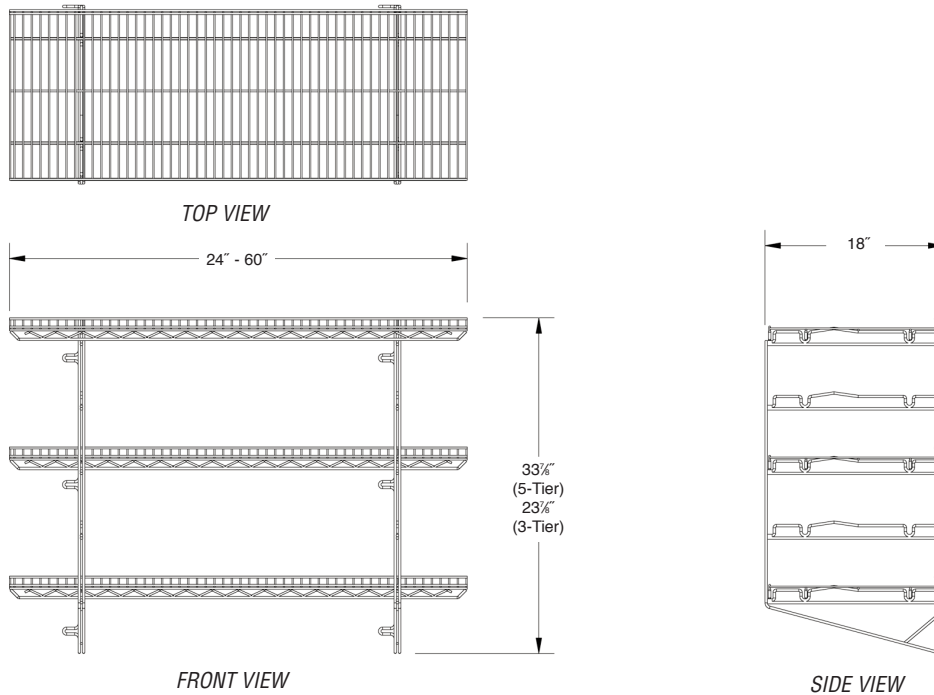

5-tier bracket kit shown with 3 shelves - S3-5B-SSW1848C

Three-Tier Bracket Kits - chrome finish, includes one pair of brackets

Shelf length x width in. mm	One Shelf		Two Shelves		Three Shelves	
	model #	list	model #	list	model #	list
18" x 24"	S1-3B-SSW1824C	\$104	S2-3B-SSW1824C	\$159	S3-3B-SSW1824C	\$213
18" x 30"	S1-3B-SSW1830C	117	S2-3B-SSW1830C	183	S3-3B-SSW1830C	248
18" x 36"	S1-3B-SSW1836C	124	S2-3B-SSW1836C	197	S3-3B-SSW1836C	271
18" x 48"	S1-3B-SSW1848C	143	S2-3B-SSW1848C	236	S3-3B-SSW1848C	328
18" x 60"	S1-3B-SSW1860C	167	S2-3B-SSW1860C	284	S3-3B-SSW1860C	401

Five-Tier Bracket Kits - chrome finish, includes one pair of brackets

Shelf length x width in. mm	Three Shelves		Four Shelves		Five Shelves	
	model #	list	model #	list	model #	list
18" x 24"	S3-5B-SSW1824C	\$232	S4-5B-SSW1824C	\$285	S5-5B-SSW1824C	\$339
18" x 30"	S3-5B-SSW1830C	267	S4-5B-SSW1830C	334	S5-5B-SSW1830C	400
18" x 36"	S3-5B-SSW1836C	289	S4-5B-SSW1836C	362	S5-5B-SSW1836C	436
18" x 48"	S3-5B-SSW1848C	346	S4-5B-SSW1848C	439	S5-5B-SSW1848C	532
18" x 60"	S3-5B-SSW1860C	419	S4-5B-SSW1860C	536	S5-5B-SSW1860C	653

Additional Chrome Shelves

width x length in. mm	weight		model #	list
	lbs.	kg		
18" x 24"	457 x 610	5	2.3	SSW1824C \$55
18" x 30"	457 x 762	6	2.7	SSW1830C 68
18" x 36"	457 x 914	7	3.2	SSW1836C 76
18" x 48"	457 x 1219	10	4.5	SSW1848C 96
18" x 60"	457 x 1524	15	6.8	SSW1860C 121

Additional Wall Brackets - chrome finish, includes one pair of brackets

width x length in. mm	weight		model #	list
	lbs.	kg		
18" x 23 1/2"	457 x 576	5	2.3	SSW18B3-C \$82
18" x 23 1/2"	457 x 576	5	2.3	SSW18B5-C 98