



# STAND

JOB NAME: \_\_\_\_\_

ITEM NO.: \_\_\_\_\_

NO. REQUIRED: \_\_\_\_\_

**PART NUMBERS:**     09-1188  
                                09-1191

**DESCRIPTION:**

Stainless steel construction, satin finish with pan slides.

The following equipment may be mounted on this stand:

- PS-3E Electric Countertop Steamer (3-Pan)
- PS-6E Electric Countertop Steamer (6-Pan)

PART NUMBER	SHIP WEIGHT
09-1188	45 lbs. (20 kg)
09-1191	55 lbs. (25 kg)

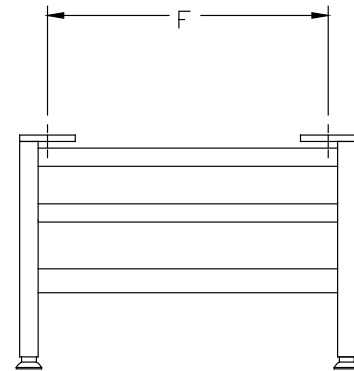
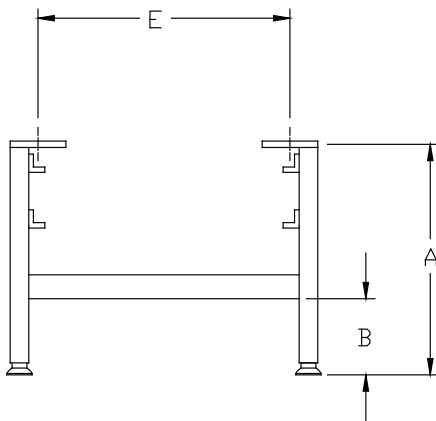
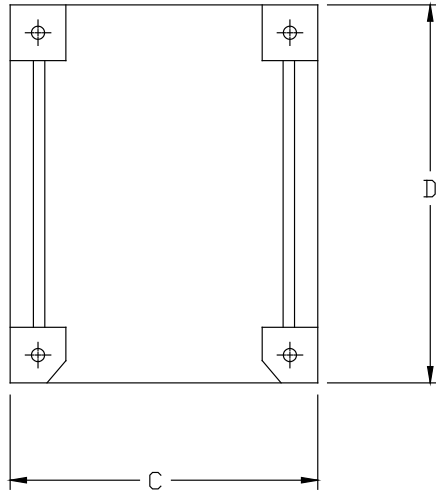
**DIMENSIONS**

PART NO.	A	B	C	D	E	F
09-1188	18.13" 460	5.75" 146	23.88" 606	27.5" 699	20.13" 511	23.44" 595
09-1191	29.13" 740	8" 203	23.88" 606	27.5" 699	20.13" 511	23.44" 595

The manufacturer reserves the right to modify materials and specifications without notice.

SPEC SHEET: S-6087  
08/11

**FOOD SERVICE EQUIPMENT**  
Stainless Steel Stand



PRINTED IN U. S. A.



**MARKET FORGE**  
INDUSTRIES INC.

35 Garvey Street • Everett • MA • 02149  
 Tel: (617) 387-47100 • Toll Free: (866) 698-3188 • Fax: (617) 387-4456 • Outside MA Fax: (800) 227-2659  
 E-Mail: [custserv@mfi.com](mailto:custserv@mfi.com) • Website: [www.mfi.com](http://www.mfi.com)