

NOR-LAKE, INCORPORATED
727 Second Street
Hudson, Wisconsin 54016

800-955-5253
715-386-2323
866-961-5253 Parts
800-388-5253 Service
715-386-4291 FAX
www.norlake.com



ADVANTEDGE™ DIRECT DRAW BEER COOLERS



NLDD59

PROJECT:

ITEM NUMBER:

MODEL NUMBER:

SPECIFICATIONS FOR: NLDD24, NLDD59, NLDD69, NLDD79, NLDD95

- **Finish:** Heavy duty stainless steel top, black vinyl coated front, sides and back. Galvanized steel interior walls with stainless steel floor.
- **Insulation:** Foamed-in-place 1-1/2" CFC free polyurethane insulation
- **Hardware:** Solid doors with locks, magnetic door gaskets, plastic breaker strips around door openings to limit the formation of any condensation. Interior LED light (except NLDD24). 3" diameter stainless steel draft towers. Heavy duty stainless steel threshold. Casters standard on NLDD24 model only.
- **Electrical:** 115 volt, 60 Hz, 1 phase with cord and NEMA 5-15P plug
- **Refrigeration:** Self-contained forced air R-134a capillary tube refrigeration system. Temperature range from +34°F to +38°F. Draft towers cooled by continuous cold air circulation. Adjustable temperature control.
- **Approvals:** ETL Sanitation listed, UL, C-UL Safety listed, approved to NSF standard for packaged food products **

STANDARD FEATURES

- Adjustable temperature control
- Black vinyl steel front, sides and back
- Free flowing refrigeration system at all times to ensure uniformly cooled product
- LED interior light (except NLDD24)
- 5" casters standard on NLDD24 model only
- 3" diameter polished stainless steel draft tower
- 1 two-way gas manifold (NLDD59 & NLDD69), 1 three-way gas manifold (NLDD79), 1 four-way gas manifold (NLDD95)
- Slide out condensing unit
- Temperature range: +34°F to +38°F
- ETL Sanitation listed, UL, C-UL Safety listed, approved to NSF standard for packaged food products **
- Warranties: 3 year parts & labor, 5 year compressor

OPTIONAL FEATURES *

- 4" plate-mounted casters
- Floor rack
- Single, double and triple tap draft tower

*Most options are available one week from receipt of order. Please contact us for specific questions.

** C-UL is Underwriters Laboratories Safety Certification Mark which indicates that UL has tested the equipment to applicable CSA Standards.

** ETL Sanitation is Underwriters Laboratories Sanitation Mark which indicates that ETL has tested the equipment to applicable NSF Standards.

DIRECT DRAW BEER COOLERS

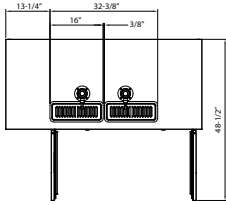

**TOP
NLDD59**

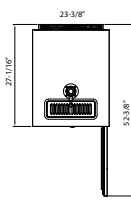

**TOP
NLDD24**

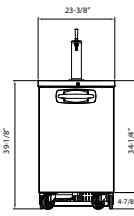

**FRONT
NLDD24**

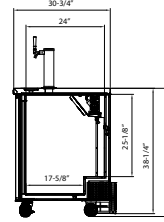

**SIDE
NLDD24**

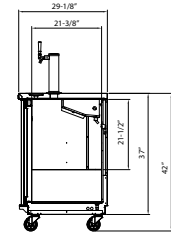

**SIDE
NLDD59, 69, 79, 95**

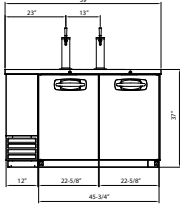

**FRONT
NLDD59**

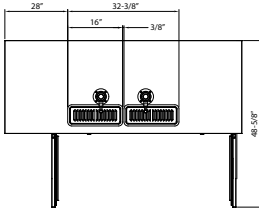

**TOP
NLDD69**

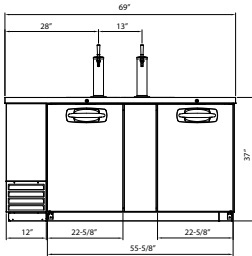

**FRONT
NLDD69**

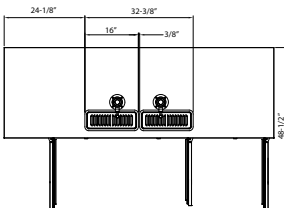

**TOP
NLDD79**

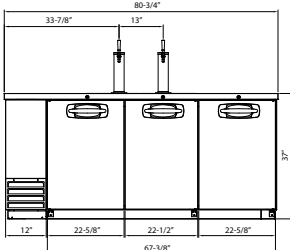

**FRONT
NLDD79**

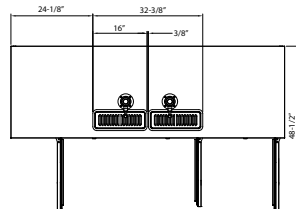

**TOP
NLDD95**

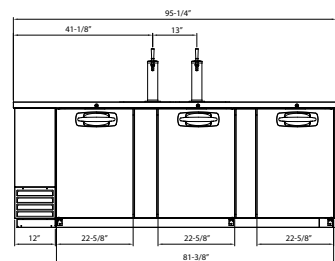

**FRONT
NLDD95**



NORLAKE[®]

Revision Date: 05/15
© 2015 NOR-LAKE, INC.
Printed in the U.S.A.
Part Number: 143585

SPECIFICATIONS

<i>Models</i>	<i>NLDD24</i>	<i>NLDD59</i>	<i>NLDD69</i>	<i>NLDD79</i>	<i>NLDD95</i>
<i>Crated Weight (lbs) (kg)</i>	187 (85)	276 (125)	298 (135)	400 (182)	460 (209)
<i>Crated Height (in) (cm)</i>	44 (112)	44 (112)	44 (112)	44 (112)	44 (112)
<i>Crated Width (in) (cm)</i>	27-1/2 (70)	61-1/2 (156)	71-1/4 (181)	82-5/8 (210)	97-5/8 (248)
<i>Crated Depth (in) (cm)</i>	30 (76)	30 (76)	30 (76)	30 (76)	30 (76)
<i>Interior Height (in) (cm)</i>	31-3/4 (81)	31-3/4 (81)	31-3/4 (81)	31-3/4 (81)	31-3/4 (81)
<i>Interior Width (in) (cm)</i>	19-3/8 (49)	54-3/4 (139)	64-3/4 (165)	76-1/2 (194)	91 (231)
<i>Interior Depth (in) (cm)</i>	24 (61)	21-3/8 (54)	21-3/8 (54)	21-3/8 (54)	21-3/8 (54)
<i>Overall Height (in) (cm)</i>	39-1/4 (100)	37 (94)	37 (94)	37 (94)	37 (94)
<i>Overall Width (in) (cm)</i>	23-3/8 (59)	59 (150)	69-1/8 (176)	80-3/4 (205)	95-1/4 (242)
<i>Overall Depth (in) (cm)</i>	30-3/4 (78)	29-1/8 (74)	29-1/8 (74)	29-1/8 (74)	29-1/8 (74)
<i>Gross Cubage (CuFt) (L)</i>	7.9 (223.7)	19.4 (549.3)	23.4 (662.6)	27.9 (790)	33.6 (951.4)
<i>Number of Towers</i>	1 single	2 single	2 single	1 single 1 double	2 double
<i>Number of Kegs</i>	1	2**	3	4	5
<i>Condensing Unit Size</i>	1/5 HP	1/5 HP	1/3 HP	1/3 HP	3/8 HP
<i>Refrigerant</i>	R-134a	R-134a	R-134a	R-134a	R-134a
<i>Electrical Characteristics</i>	115/60/1	115/60/1	115/60/1	115/60/1	115/60/1
<i>Cord and Plug Furnished</i>	Yes	Yes	Yes	Yes	Yes
<i>NEMA Plug Configuration</i>	5-15P	5-15P	5-15P	5-15P	5-15P
<i>Total Amp Draw</i>	3.3	3.3	5.0	6.0	6.3

Specifications subject to change without notice.

** The NLDD59 will hold (2) 1/2 barrel kegs and (1) slim quarter barrel.