



ROYAL SERIES UNDERBAR TRASH STATIONS

MODEL: _____ PROJECT: _____ ITEM #: _____ QTY: _____

PRODUCT IMAGE



STANDARD FEATURES

- **Front Apron**
20 gauge stainless steel clad over 20 gauge galvanized steel
- **Backsplash**
20 gauge stainless steel
- **Sides**
20 gauge stainless steel
- **Door**
20 gauge stainless steel
- **NOTE: Trash receptacle not included**

KR18-T12 SHOWN

AVAILABLE IN 1800 SERIES



CERTIFICATIONS:

APPROVED BY:

Due to our commitment to continued product improvement, specifications are subject to change without notice.

Printed in the USA

Krowne Metal Corporation

100 Haul Rd. Wayne, NJ 07470 • Toll Free: (800) 631-0442 • Fax: (973) 872-1129
sales@krowne.com • www.krowne.com • www.facebook.com/KrowneMetal • www.twitter.com/KrowneMetal

KaTom Restaurant Supply, Inc.

Rev. 09/2011
No. 5.17



ROYAL SERIES UNDERBAR TRASH STATIONS

MODEL: _____ PROJECT: _____ ITEM #: _____ QTY: _____

1800 SERIES

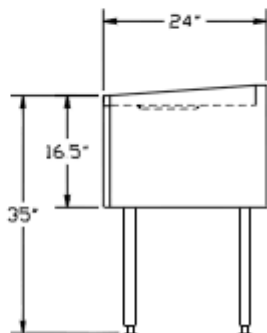
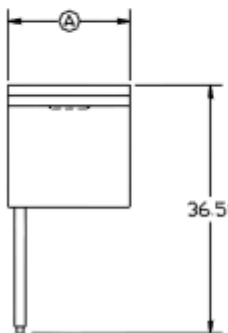
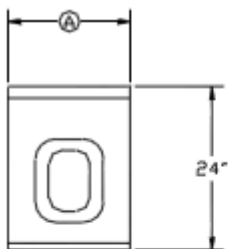

Model Numbers	Overall Length Ⓐ	Location of Legs	Depth	Weight (lbs.)
KR18-T12	12"	N/A	24"	39
KR18-T14L	14"	Left	24"	45
KR18-T14R	14"	Right	24"	45



APPROVED BY: _____

CERTIFICATIONS:

Due to our commitment to continued product improvement, specifications are subject to change without notice.

Printed in the USA

Krowne Metal Corporation

100 Haul Rd. Wayne, NJ 07470 • Toll Free: (800) 631-0442 • Fax: (973) 872-1129
 sales@krowne.com • www.krowne.com • www.facebook.com/KrowneMetal • www.twitter.com/KrowneMetal

Rev. 09/2011
No. 5.17

KaTom Restaurant Supply, Inc.