

### Cucina Marcella



#### FEATURES:

- Enclosed Base Cabinet
- Food Service Grade 300 Series 18/8 Stainless
- 16 Gauge Stainless Steel Top
- Doors with Recessed Handles and Nylon Roller Bearing Glides
- Strongest and Most Durable Table Available
- 36" High Overall

Model	Size	Wt
CU160-16	48"x30"	130
CU160-17	60"x30"	153
CU160-18	72"x30"	183
CU160-19	96"x30"	230

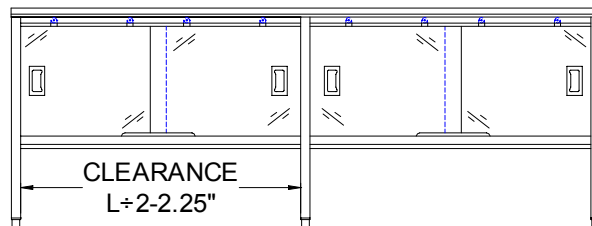
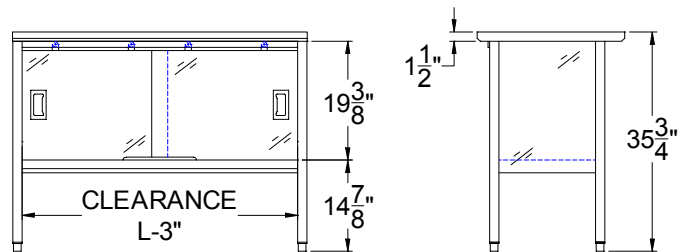
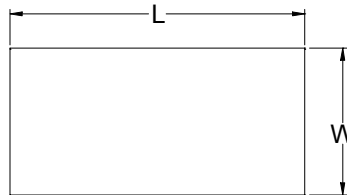

#### MATERIAL:

- Top: 16 gauge type 304 stainless steel,  
Type 304 stainless steel # 3 polish, satin finish
- Base: 18 gauge type 304 stainless steel, # 3 polish, satin finish  
Type 304 stainless steel # 3 polish, satin finish

### **John Boos & Co**

315 South First Street - Effingham, IL 62401

Phone: 217-347-7701 - Fax: 217-347-7705

Email: sales@johnboos.com - Web-site: www.johnboos.com

Z-12