



### Cucina D'Vino

#### FEATURES:

- \* 2-1/4" Thick Edge Grain Hard Rock Maple Top
- \* Finished w/ Varnique
- \* Food Service Stainless Steel Legs, Undershelf and Towel Bar
- \* Type 18/304 stainless steel # 3 polish, satin finish
- \* Commercial Grade 3" Locking Casters
- \* 35" High Overall
- \* Optional Dovetailed Maple Drawer w/ Stainless Steel Front
- \* Optional Wine Rack
- \* Shipped knocked-down, easy - to - assemble
- \* UPSable

| Model  | Size    | Wt |
|--------|---------|----|
| CUCD09 | 30"x20" | 90 |

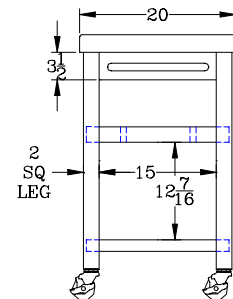
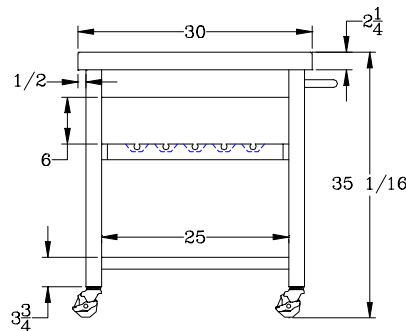
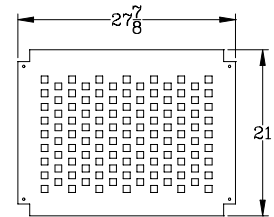
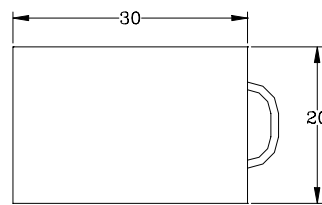

#### MATERIAL:

- Top: Edge Grain Hard Rock Maple  
 Wine Rack: Maple  
 Shelf: 18 gauge type 304 stainless steel, # 3 polish, satin finish  
 Legs: 18 gauge type 304 stainless steel, # 3 polish, satin finish

### **John Boos & Co**

315 South First Street - Effingham, IL 62401

Phone: 217-347-7701 - Fax: 217-347-7705

Email: sales@johnboos.com - Web-site: www. johnboos.com