

F-801M_H-C

MODULAR CUBELET ICE MACHINE

SLIM-LINE SERIES

Item # _____

Project: _____

Qty: _____
 *AutoCad available on KCL

F-801M_H-C

8/14

Item #I3056

CUBELET DIMENSIONS

W x D x H

F-801M_H-C

22 x 27^{3/8} x 25^{15/16}



B-300

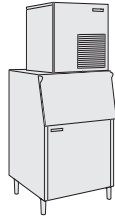

B-500

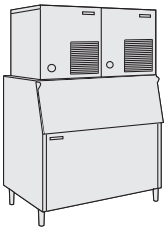

B-700

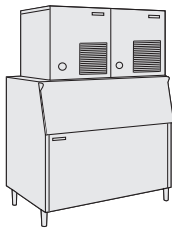

B-800

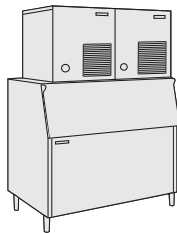

B-900

Also available on Large Bins:

B-1150SS
 B-1300SS
 B-1500SS
 B-1650SS

*CUBELET DIMENSIONS

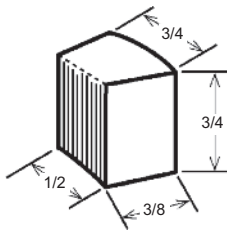

*approximate size in inches, image not to scale



F-801MAH-C

Air-Cooled

Shown on an optional
 B-500

F-801MWH-C

Water-Cooled

- Up to 728 lbs. of ice production per 24 hours
- Durable stainless steel exterior
- Advanced CleanCycle24® Design
- 2 second rinse every hour
- Removes sediment
- Cleaner ice
- Longer life and easy maintenance
- Removable air filters (Air-cooled model only)
- R-404A Refrigerant



* The F-801MAH-C is ENERGY STAR qualified.

Warranty

Valid in United States, Canada, Puerto Rico, & U.S. Territories. Contact factory for warranty in other countries.

Three Year - Parts & Labor on entire machine. (Serial numbers Vxxxxxj and after.)

Five Year - Parts on Compressor; air-cooled condenser coil.



ISO9001-15014:2001

© HOSHIZAKI AMERICA, INC.

618 Hwy. 74 S., Peachtree City, GA 30269

TEL 1-800-438-6087

FAX 1-800-345-1325

www.hoshizaki.com



DIMENSIONS
W x D x H
F-80IM_H-C
22 x 27^{3/8} x 25^{15/16}

- Air-cooled
- Water-cooled

AIR-COOLED

Water Temp ° F.	50°	70°	90°
Air Temp ° F. 70°	728	698	670
Air Temp ° F. 80°	644	618	593
Air Temp ° F. 90°	569	559	524

WATER-COOLED

Water Temp ° F.	50°	70°	90°
Air Temp ° F. 70°	627	604	592
Air Temp ° F. 80°	580	568	556
Air Temp ° F. 90°	545	535	523

UTILITY CONSUMPTION

Model Number	Approx. Elec. Watts		KWH per 100 LBS.		Potable Water Gal. per 100 lbs.	Cond. Water Gal. per 100 lbs.	
	90/70	70/50	90/70	70/50		90/70	70/50
F-801MAH-C	1038	976	4.51	3.22	12.0	N/A	N/A
F-801MWH-C	951	945	4.27	3.62	12.0	64	37

SPECIFICATIONS

Model Number	Condenser	Amperage	Min. Circuit Ampacity	Shipping Weight
F-801MAH-C	Air-Cooled	11.4	20	205 lbs.
F-801MWH-C	Water-Cooled	10.5	20	205 lbs.

STORAGE BINS

Model Number	Application Capacity	ARI-Rated Capacity
B-300	300 lbs.	260 lbs.
B-500	500 lbs.	360 lbs.
B-700	700 lbs.	550 lbs.
B-800	800 lbs.	600 lbs.
B-900	900 lbs.	660 lbs.
B-1150	1150 lbs.	N/A
B-1300	1275 lbs.	N/A
B-1500	1490 lbs.	N/A
B-1650	1605 lbs.	N/A

ELECTRICAL & PLUMBING/F-80IM_H-C

- 115-120V/60/1
- 20 amp Max Fuse/HACR Breaker Size
- 3/8" OD copper or equivalent independent water supply
- 3/4" FPT independent drain connection



© HOSHIZAKI AMERICA, INC.

618 Hwy. 74 S., Peachtree City, GA 30269

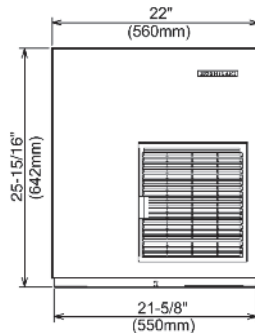

FRONT VIEW

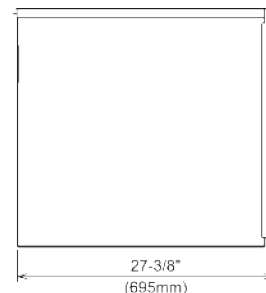

SIDE VIEW

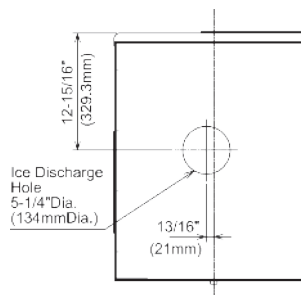

ICE DROP ZONE

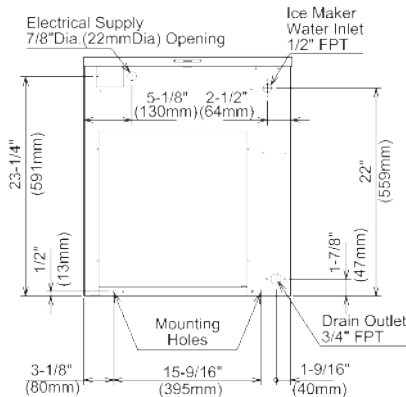

AIR-COOLED UNIT

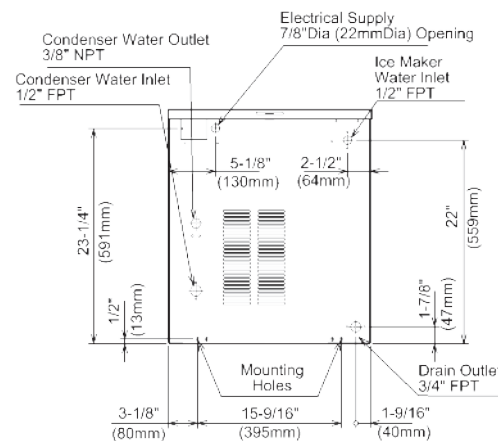

WATER-COOLED UNIT

OPERATING LIMITS

- Ambient Temp Range 45 - 100°F
- Water Temp Range 45 - 90°F
- Water Pressure 10 - 113psig
- Voltage Range 104 - 127V

SERVICE

- Panels easily removed and all components accessible for service.
- Removable/cleanable air filter (Air-Cooled model only)

