

# HUF40/68A

## UNDERCOUNTER FREEZERS

TEMPGUARD® Self-Contained Undercounter Freezers with EverCheck® Controls

Item # \_\_\_\_\_

Project: \_\_\_\_\_

Qty: \_\_\_\_\_

\*AutoCad available on KCL

HUF40/68A

8/06

Item # 13157

### HUF40A DIMENSIONS

W x D x H

40.25 x 32.3 x 33.9\*

\*with 4" casters

### HUF68A DIMENSIONS

W x D x H

68 x 32.3 x 33.9\*

\*with 4" casters

### HUF40A

Shown



### HUF68A

Shown



- Stainless steel interior and exterior top, front, sides and bottom with galvanized steel back for long life, durability and easy maintenance
- (2) heavy duty epoxy shelves per section are standard, mounted on stainless steel pilasters, shelves are adjustable in 1" increments
- Cabinet door perimeter heater provides condensation control in high humidity environments and is equipped with a back-up heater should the primary heater fail
- Cabinet and doors are insulated with 2 1/4" CFC free, foamed-in-place polyurethane
- 4" heavy duty casters (2 with brakes) are standard
- Doors are constructed of high-grade 300 series stainless steel inside and out
- Doors are self-closing with a stay open feature at 105°
- Stepped door design protects door gasket when product is removed from the cabinet; Snap in magnetic door gaskets are durable and easily removed
- Door hinging is reversible at the factory
- High-efficiency refrigeration system is designed with a large capacity condenser and evaporator resulting in lower overall power consumption.
- TempGuard's® EverCheck® controls monitor high and low temperatures, high pressure, clean filter and cabinet temperature functions and provide visual alarms to alert operator to possible problems
- Cartridge-style refrigeration system is easily removable from the main unit for ease of service
- Evaporator coil is coated for extended life
- Refrigeration system is equipped with solid state digital controls (Fahrenheit or Celsius display)
- Refrigeration system is designed to maintain proper temperatures with "zero" clearance on ends and at rear
- Defrost cycles are time initiated - temperature terminated and can be set to cycle from one to twelve hours to prevent ice formation and maintain optimum cabinet temperatures
- Removable, cleanable air filter protects condenser and reduces cleaning requirements
- Hot gas condensate evaporator is standard
- Units equipped with 8' - 6" cord and plug
- Refrigerant: R-404A with capillary tube controls

\* The HUF68A undercounter freezer is ENERGY STAR certified.



### Warranty

Valid in United States, Canada, Puerto Rico, & U.S. Territories. Contact factory for warranty in other countries.

**Two Year** - Parts & Labor on entire machine.

**Five Year** - Parts on: Compressor.



# Hoshizaki

## HUF40/68A UNDERCOUNTER FREEZERS

**DIMENSIONS**  
W x D x H  
**HUF40A**  
40.25 x 32.3 x 33.9  
\*with 4" casters  
**HUF68A**  
68 x 32.3 x 33.9  
\*with 4" casters

### UNDERCOUNTER FREEZERS

- 1 section undercounter freezer
- 2 section undercounter freezer

#### DIMENSIONS/CAPACITY

Model #	HUF40A	HUF68A
Interior Storage Capacity (CF)	8.5 ft <sup>3</sup>	18.8 ft <sup>3</sup>
Overall Width	40.25"	68"
Overall Depth	32.3"	32.3"
Height (including 4" casters)	33.9"	33.9"
Depth with Door open at 90°	56.8"	56.8"
Door Opening Width	22.5"	22.5"
Door Opening Height	24.3"	24.3"
Adjustable Shelves	2	4
Shelf Dimensions (W x D)	22.4" x 24.6"	25" x 24.6"
Crated Shipping Weight	317 lb	442 lb
Crated Height	35.5"	35.5"
Crated Width	44.25"	72"
Crated Depth	35.5"	35.5"

#### ELECTRICAL & REFRIGERATION DATA

Model #	HUF40A	HUF68A
Voltage	115/60/1	115/60/1
Amperage	5.8	9.3
HACR Breaker	15.0	15.0
Electrical Connection(NEMA)	5 - 15P	5 - 15P
*Energy Consumption(kwh/day)	8.0	11.0
* Heat Rejection(BTU/Hr.)	1133	1565
Approximate Nominal Compressor BTU/Hr.(HP)	1378 (3/8HP)	2592 (1/2HP)
Voltage Range	104 - 126	104 - 126
Ambient Temp. Range	45° - 100°F	45° - 100°F
Control Setpoint Range	-13° to +19°	-13° to +19°
*Refrigerant	R-404A	R-404A

\* Based on 100°F ambient cycling at setpoint

#### OPTIONS

- 6" Legs
- 6" Casters
- Foot pedal
- Stainless steel back
- Tray pan rack slides (accommodates 18" x 26" pans)
- Bullnose top (front & rear)
- Drawers
- Reversible hinges
- Additional epoxy shelves



© HOSHIZAKI AMERICA, INC.

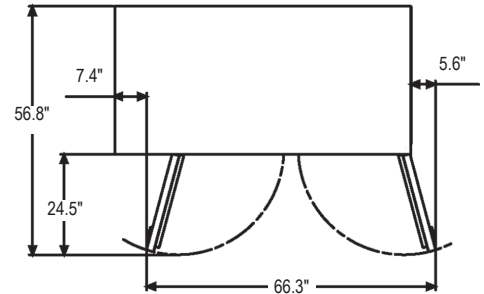
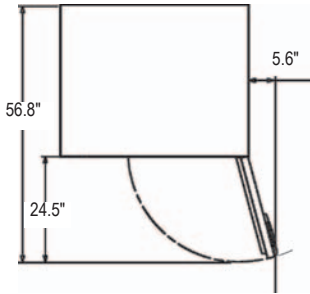

DOOR SWING

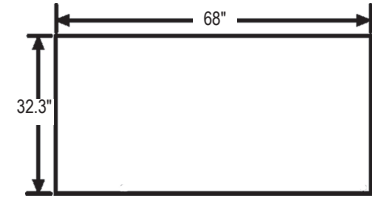
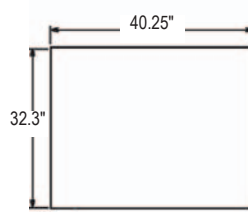

PLAN VIEW

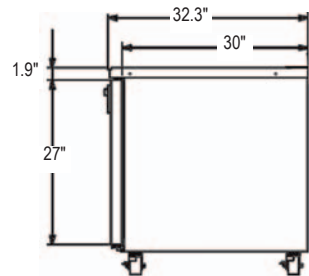

SIDE VIEW (BOTH UNITS)

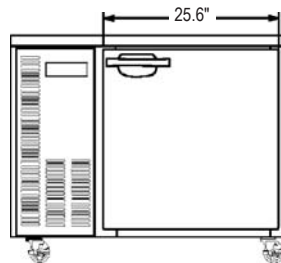

HUF40A

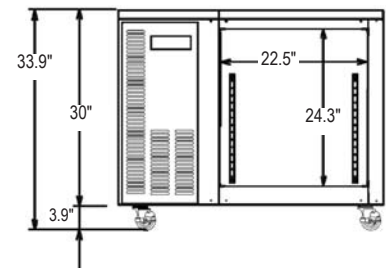

HUF68A

